

Withdrawn 8/8/06

Submitted by: Chair of the Assembly at
the Request of the Mayor
Prepared by: Planning Department
For reading: September 12, 2006

1
2
3
4
5
6
7
8
9
10
11
12
13
14
15
16
17
18
19
20
21
22
23
24
25
26
27
28
29
30
31
32
33
34
35
36
37
38
39
40
41
42
43
44
45

Anchorage, Alaska
AR 2006-163

A RESOLUTION OF THE ANCHORAGE MUNICIPAL ASSEMBLY APPROVING A MINOR AMENDMENT TO AN EXISTING ALCOHOLIC BEVERAGES CONDITIONAL USE IN THE B-3 DISTRICT FOR A RESTAURANT/EATING PLACE PER AMC 21.40.180 D.8 FOR CHUCK E. CHEESE RESTAURANT, LOCATED AT 308 EAST NORTHERN LIGHTS BOULEVARD, CALAIS SUBDIVISION, TRACT D3, GENERALLY LOCATED ON THE SOUTH SIDE OF NORTHERN LIGHTS BOULEVARD BETWEEN DENALI AND A STREET.

(Mid-Town Community Council) (Case 2006-082)

THE ANCHORAGE ASSEMBLY RESOLVES:

Section 1. The minor amendment to an existing conditional use permit for an Alcoholic Beverages Conditional Use in the B-3 District for a Restaurant/Eating Place use per AMC 21.40.180 D.8 for Chuck E. Cheese Restaurant; located on Calais Subdivision, Tract D3, site address being 308 East Northern Lights Boulevard, generally meets the applicable provisions of AMC 21.15.030.G.

Section 2. The existing alcoholic beverages restaurant/eating place conditional use is for the first floor. This minor amendment expands their restaurant license number 1744 to include the second floor. The restaurant will occupy both floors of the 18,288 square-foot building. The total seating capacity is 448: 272 on the first floor and 176 on the second floor. This requires 153 required parking spaces. The operational plan will not change. The hours of operation remain 9:00 A.M. to 10:00 P.M., Sunday through Thursday, and 9:00 A.M. to 11:00 P.M., Friday and Saturday. All retail clerks are over the age of 21, and are trained in "Techniques in Alcohol Management" (TAM). The ratio of food sales to alcohol beverage sales is sixty-four percent to three percent respectively. An additional one third of revenue is from family games and children's rides.

Section 3. This minor amendment has no significant effect to the surrounding neighborhood.

Section 4. The subject conditional use permit for an Alcoholic Beverages Conditional Use in the B-3 District for Restaurant/Eating Place per AMC 21.40.180 D.8 is subject to the following conditions:

1. A Notice of Zoning Action shall be filed with the State District Recorder's Office within 120 days of the Assembly's approval of a final conditional use approval for the subject alcoholic restaurant/eating place in the B-3 District.
2. All uses shall conform to the plans and narrative submitted.

1
2
3
4
5
6
7
8
9
10
11
12
13
14
15
16
17
18
19
20
21
22
23
24
25
26
27
28
29
30
31
32
33
34
35
36

- 3. This minor amendment conditional use shall become effective with an executed joint-parking agreement for the required parking in accordance with AMC 21.45.080. The lots are within the Calais Subdivision, Tracts D5-1, 5-2A, D-1B1, D4 and D3.
- 4. The use of the property by any person for the permitted purposes shall comply with all current and future Federal, State and local laws and regulations including, but not limited to, laws and regulations pertaining to the sale, dispensing, service and consumption of alcoholic beverages and the storage, preparation, sale, service and consumption of food. The owner of the property, the licensee under the Alcoholic Beverage Control License and their officers, agents and employees, shall not knowingly permit, or negligently fail to prevent the occurrence of illegal activity on the property.
- 5. Upon demand, the applicant shall demonstrate compliance with a "Liquor Server Awareness Training Program" approved by the State of Alaska Alcohol Beverage Control Board, such as or similar to, the program for "Techniques in Alcohol Management" (TAM).
- 6. A copy of the conditions imposed by the Assembly in connection with this conditional use approval shall be maintained on the premises at a location visible to the public.

Section 5 Failure to comply with the conditions of this conditional use permit shall constitute grounds for modification or revocation.

Section 6. This resolution shall become effective immediately upon passage and approval by the Anchorage Assembly.

PASSED AND APPROVED by the Anchorage Assembly this _____ day of _____ 2006

ATTEST:

Chair

Municipal Clerk

(Planning Case 2006-082)
(Tax Id. 009-041-06)



**MUNICIPALITY OF ANCHORAGE
ASSEMBLY MEMORANDUM**

No. AM 444-2006

Meeting Date: September 12, 2006

From: Mayor

Subject: MINOR AMENDMENT TO AN EXISTING ALCOHOLIC BEVERAGES
CONDITIONAL USE IN THE B-3 DISTRICT FOR A
RESTAURANT/EATING PLACE PER AMC 21.40.180 D.8 FOR CHUCK
E. CHEESE RESTAURANT LOCATED IN THE CALAIS SUBDIVISION,
TRACT D3, LOCATED AT 308 EAST NORTHERN LIGHTS
BOULEVARD.

1
2 On May 17, 2005, Assembly Memorandum 339-2005 approved the transfer of ownership
3 and location of a restaurant/eating place license number 1744 from C & A Restaurants Inc.
4 to CEC Entertainment Inc., located at 308 East Northern Lights Boulevard. Assembly
5 Memorandum number 145-82, adopted February 7, 1982, granted the initial
6 restaurant/eating place conditional use. The property is zoned B-3.

7
8 CEC Entertainment Inc. has made application for a minor amendment to the existing
9 alcoholic beverages restaurant/eating place conditional use license number 1744 located at
10 308 East Northern Lights Boulevard, to allow expansion of their restaurant to include the
11 second floor.

12
13 Currently, the restaurant is located entirely on the first floor of the two-story building.
14 They occupy 11,057 square feet on the first floor, and have a building permit pending to
15 remodel both floors of the building interior, including some areas affecting food and
16 alcohol sales. There are 11,057 square feet on the first floor and 7,231 square feet on the
17 second floor. When completed, the total seating capacity is 448: 272 on the first floor and
18 176 on the second floor. This requires a total of 153 required parking spaces.

19
20 The building Permit for remodeling the second floor has not been issued. Plan Review
21 comments note that the Zoning Plan Review is incomplete. They require the applicant to
22 submit parking calculations, a seating chart for each floor, and a site plan depicting
23 existing and proposed parking with landscaping. Calais, Inc. owns Tracts D5-1, D5-2A,
24 D-1B1, D4 and the subject parcel, D3. At present, the applicant has 32 conforming parking
25 spaces and 18 nonconforming parking spaces that cross lot lines on Tracts D3 and D4.
26 Land Use Enforcement has indicated that the site plan showing all parking for all tracts

1 shows a similar full/partial parking plan for Tracts D4 and D-1B1. Their solution is a
2 joint-parking agreement linking the five tracts. This option is being pursued by the
3 applicant, and issuance of the building permit is pending this option.
4

5 The Chuck E. Cheese operational plan will not change. Hours of operation remain
6 unchanged: 9:00 A.M. to 10:00 P.M., Sunday through Thursday, and 9:00 A.M. to 11:00
7 P.M., Friday and Saturday. All retail clerks are TAM trained and are over 21 years of age.
8 The ratio of food sales to alcohol beverages sales is 64 percent and two to three percent
9 respectively. One third of revenue is from family games and children's rides. There are no
10 churches or schools within 200 feet of the property.
11

12 AMC 21.15.030.G.2 (a) requires: "the Assembly, upon an express finding that the
13 proposed modifications will have a significant effect on the surrounding neighborhood or
14 on owners or occupiers of adjacent property that is the subject of the modification
15 application, may determine that a public hearing is necessary. In such event the hearing
16 shall be scheduled as soon as practicable after the matter first comes before the body for
17 conclusion."
18

19 The Planning Department recommends approval of the request as a minor amendment
20 subject to a properly executed joint parking agreement involving Calais Subdivision,
21 Tracts D5-1, 5-2A, D-1B1, D4 and D3. The agreement shall be recorded with the Alaska
22 State District Recorder's Office within one year from the date this minor amendment.
23 Approval of this memorandum will GRANT the increase in size of the restaurant to
24 include the second floor as a minor amendment to the existing alcohol conditional use.
25

26 Prepared by: Jerry T. Weaver Jr., Zoning Administrator, Planning Department

27 Concur: Tom Nelson, Director, Planning Department

28 Concur: Mary Jane Michael, Executive Director, Office of Economic and
29 Community Development

30 Concur: Denis C. LeBlanc, Municipal Manager

31 Respectfully submitted: Mark Begich, Mayor
32
33
34

(Tax Parcel number 009-041-06)

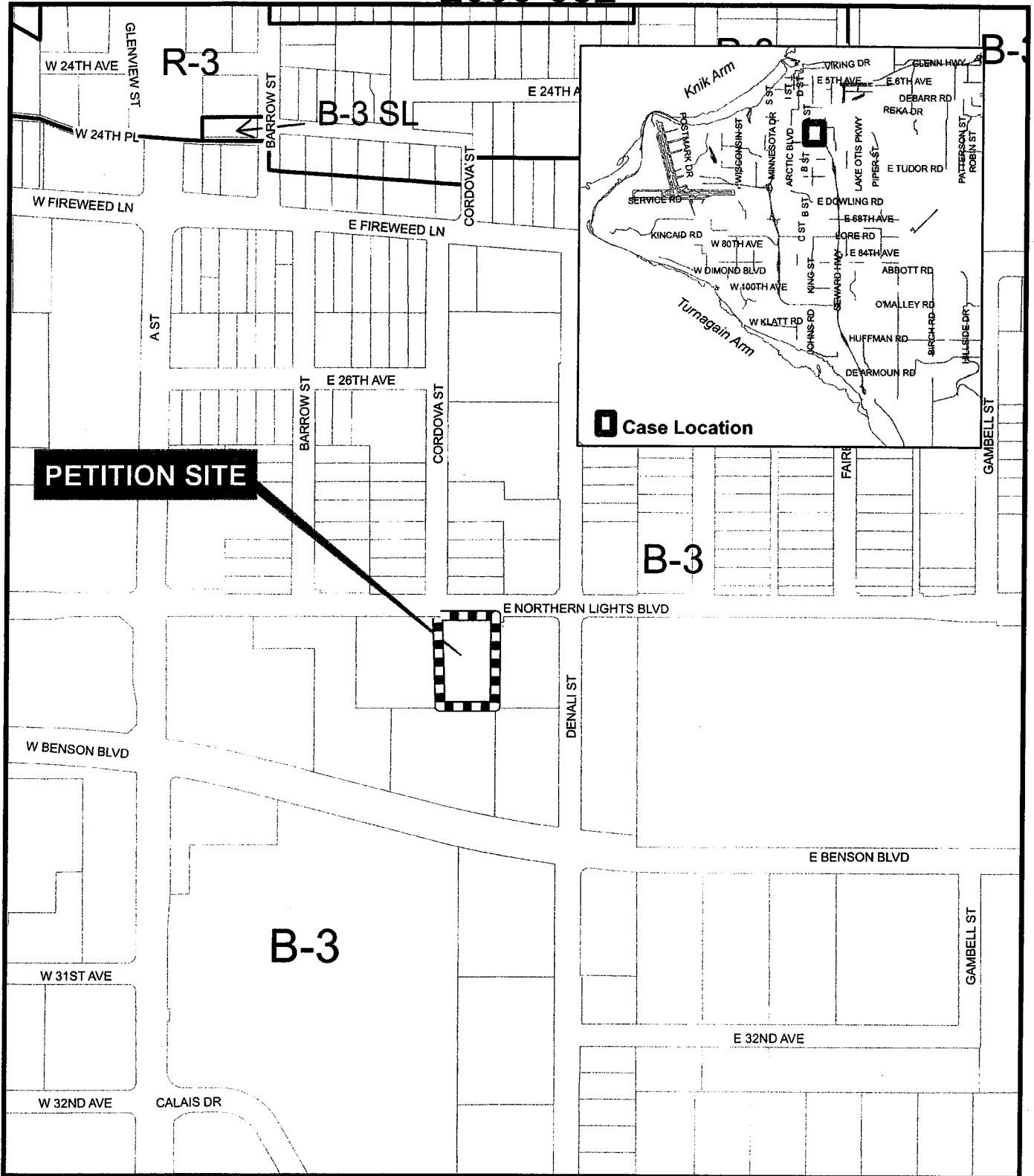

CONDITIONAL USE-ALCOHOL 2006-082



Municipality of Anchorage
Planning Department

Date: June 1, 2006

Flood Limits

-  100 Year
-  500 Year
-  Floodway

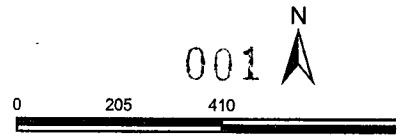

APPLICATION

CEC

entertainment

4441 W. AIRPORT FRWY.
IRVING, TEXAS 75062
(T) 972.258.8507
(F) 972.258.8545

RECEIVED

MAY 03 2006

Municipality of Anchorage
Zoning Division

Alice Winters
Director of Licensing
Phone: 972-258-5523
Fax: 972-258-5534

May 2, 2006

Mary Autor
Zoning Officer
Municipality of Anchorage
4700 S. Bragaw
Anchorage, Alaska 99507
Ph: 907/343-7941

Via: Federal Express

Re: Chuck E. Cheese's #589
308 E. Northern Lights Boulevard
Anchorage, Alaska 99503

Dear Ms. Tutor:

Pursuant to our recent conversations, CEC plans to repair, remodel and make use of the second story for the Chuck E. Cheese's. The building is in disrepair and needs major work and remodel immediately. Since CEC is not adding any square footage to the footprint of the building – only making better use of what is existing – I understand the Amendment process will be considered a Minor Amendment.

We inquired about the 1982 Assembly Memorandum during the acquisition in January 2005 – and understood no action was needed. CEC chose to suspend alcohol sales until the remodeling is complete.

For the amendment, enclosed herewith are the following documents:

1. *Application For Conditional Use AMENDMENT;*
2. *Information and copies regarding the Liquor License Application and Waiver of Operation;*
3. *Chuck E. Cheese's Operation Statement;*
4. *Chuck E. Cheese's Alcohol Training Booklet (yellow/green in color)*
5. *CEC floor plan – prior to remodel (dated Jan 2005)*
6. *CEC exterior elevations*
7. *Map to CEC;*
8. *Floor Plan A1.1- 2002 floor plan before remodel;*
9. *Floor Plan A1.2 ground floor after remodel;*
10. *Floor Plan A1.3 second floor after remodel;*
11. *OCC1 – Occupancy Plan – Ground Level*
12. *OCC2 – Occupancy Plan – Second Floor*
\$960.00 corporate check #439100 for Minor Amendment.

Page 2
Mary Autor, Zoning Officer
May 2, 2006

If you have questions or need additional information, please let me know.

Sincerely,

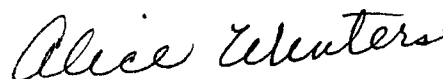
A handwritten signature in cursive script that reads "Alice Winters".

Alice Winters

BANKSTON GRONNING O'HARA

A PROFESSIONAL CORPORATION
ATTORNEYS AT LAW
601 W. 5TH AVENUE, SUITE 900
ANCHORAGE, ALASKA 99501
(907) 276-1711
FACSIMILE (907) 279-5358
WWW.BANKSTON.TO

SHAREHOLDERS

WILLIAM M. BANKSTON
JON T. GIVENS
CHRIS D. GRONNING
CHRISTOPHER J. HEAPHEY
BARBRA Z. NAULT
STEVEN T. O'HARA

ASSOCIATES

BRIAN J. STIBITZ
D. KEVIN WILLIAMS

May 31, 2006

via EMAIL: autormp@muni.org

Mary Autor
Senior Planner
Municipality of Anchorage
Planning and Zoning
3700 S. Bragaw
Anchorage, Alaska 99519-6650

Re: *MOA Permit No. 05-6389*
Our File No.: F-3221-07

Dear Ms. Autor:

This will confirm our telephone conversation of May 30, 2006. This law firm represents Fathers, Inc. and is assisting CEC to obtain its building permit.

We have prepared an Agreement to Provide Off-Street Parking for execution by the Calais Company. This Agreement has the Calais Company as owner and is executing this Agreement on behalf of the sublessees for certain tracts (Neighbors). This Agreement has Calais Company as the owner of Tract D5 of the Calais Subdivision. This Agreement has Calais Company executing it on behalf of the sublessees for Tracts D5-1, D5-2A, D4, and D-1B1 of the Calais Subdivision.

In our conversation, you requested a letter of assurance from the undersigned that this Agreement was in the process of being executed by the Calais Company, or alternatively, that it would be executed by Calais Company and Neighbors who are current sublessees of this property.

The Municipality of Anchorage is now convinced that there are sufficient parking spaces for the current uses that are being conducted on these parcels. This letter confirms that your office will allow the building permit to be issued. However, there will not be a final Certificate of Occupancy issued until the Agreement to Provide Off-Street Parking

Mary Autor
May 31, 2006
Page 2

is recorded. The fact that the Agreement to Provide Off-Street Parking is not executed at this date will not prevent the issuance of the building permit.

Father's, Inc. and CEC will continue to work with the Calais Company to facilitate this Agreement's execution by the appropriate parties and recordation.

If you have any questions, or if the above is not acceptable and the building permit will not be issued forthwith, please do not hesitate to contact me.

Very truly yours,

BANKSTON GRONNING O'HARA, P.C.

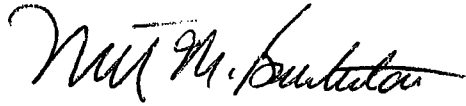

William M. Bankston

WMB:jea
cc: Father's, Inc.
CEC Entertainment
Vern Hickel Construction Co.

F3221\07\LTRautorWMBI

Application for Conditional Use Retail Sale Alcoholic Beverages

Municipality of Anchorage
Planning Department
PO Box 196650
Anchorage, AK 99519-6650

Please fill in the information asked for below. **AMENDMENT TO CONDITIONAL USE PERMIT**

PETITIONER*	PETITIONER REPRESENTATIVE (IF ANY)
Name (last name first) CEC ENTERTAINMENT, Inc.	Name (last name first) Winters, Alice
Mailing Address 4441 West Airport Freeway, Irving, TX 75062	Mailing Address 4441 West Airport Freeway, Irving, TX 75062
Contact Phone: Day: 972/258-5523 Night: 214/616-8973 cell	Contact Phone: Day: 972/258-5523 Night: 214/616-8973 cell
FAX: 972/258-5534	FAX: 972/258-5534
E-mail: awinters@cecentertainment.com	E-mail: awinters@cecentertainment.com

* Report additional petitioners or disclose other co-owners on supplemental form. Failure to divulge other beneficial interest owners may delay processing of this application.

PROPERTY INFORMATION		
Property Tax #(000-000-00-000): 009-041-06-000		
Site Street Address: 308 E. Northern Lights Blvd. Anchorage, Ak 99503		
Property Owner (if not the Petitioner): Fathers, Inc.		
Current legal description: (use additional sheet in necessary) Tract D-3 Calais Subdivision		
Please see attached		
Zoning: B-3	Acreage: 37,950sf	Grid # N/A

ALCOHOLIC BEVERAGE CONTROL BOARD LICENSE PROPOSED		
<input type="checkbox"/> Beverage Dispensary	<input type="checkbox"/> Private Club	<input type="checkbox"/> Restaurant, exempt
<input type="checkbox"/> Beverage Dispensary-Tourism	<input type="checkbox"/> Public Convenience	<input type="checkbox"/> Theater
<input type="checkbox"/> Brew Pub	<input type="checkbox"/> Recreational	<input type="checkbox"/> Other (Please explain):
<input type="checkbox"/> Package Store	<input checked="" type="checkbox"/> Restaurant	
Is the proposed license: <input type="checkbox"/> New	<input checked="" type="checkbox"/> Transfer of location: ABC license number: #1744 was transferred 7/13/05	
	Transfer license location: 308 E. Northern Lights Blvd. Anchorage, Ak 99503	
	Transfer licensed premises doing business as: Chuck E. Cheese's	

I hereby certify that (I am) (I have been authorized to act for) owner of the property described above and that I petition for a retail sale of alcoholic beverages conditional use permit in conformance with Title 21 of the Anchorage Municipal, Code of Ordinances. I understand that payment of the application fee is nonrefundable and is to cover the costs associated with processing this application, and that it does not assure approval of the conditional use. I also understand that assigned hearing dates are tentative and may have to be postponed by Planning Department, Municipal Clerk, or the Assembly for administrative reasons.

Date 4-27-06	CEC ENTERTAINMENT, Inc. By: <i>Alice Winters</i> Alice Winters, Ass't Sec/Ass't Treas		
Accepted by: <i>MA</i>	Poster & Affidavit: <i>N/A</i>	Fee \$960	Case Number 2006-082

COMPREHENSIVE PLAN INFORMATION not applicable for Amendment *aw*

Anchorage 2020 Urban/Rural Services: Urban Rural

Anchorage 2020 West Anchorage Planning Area: Inside Outside

Anchorage 2020 Major Urban Elements: Site is within or abuts:

- Major Employment Center Redevelopment/Mixed Use Area Town Center
 Neighborhood Commercial Center Industrial Center
 Transit - Supportive Development Corridor

Eagle River-Chugiak-Peters Creek Land Use Classification: N/A

- Commercial Industrial Parks/opens space Public Land Institutions
 Marginal land Alpine/Slope Affected Special Study
 Residential at _____ dwelling units per acre

Girdwood- Turnagain Arm N/A

- Commercial Industrial Parks/opens space Public Land Institutions
 Marginal land Alpine/Slope Affected Special Study
 Residential at _____ dwelling units per acre

ENVIRONMENTAL INFORMATION (All or portion site affected) not applicable for Amendment *aw*

- Wetland Classification: None "C" "B" "A"
 Avalanche Zone: None Blue Zone Red Zone
 Floodplain: None 1 00 year 500 year
 Seismic Zone (Harding/Lawson): "1" "2" "3" "4" "5"

RECENT REGULATORY INFORMATION (Events that have occurred in last 5 years for all or portion site)

- Rezoning - Case Number:
 Preliminary Plat Final Plat - Case Number(s):
 Conditional Use - Case Number(s): title "Assembly Memorandum" dated 2-9-82 to be amended *aw*
 Zoning variance - Case Number(s):
 Land Use Enforcement Action for
 Building or Land Use Permit for
 Wetland permit: Army Corp of Engineers Municipality of Anchorage

DOCUMENTATION

- Required: Site plan to scale depicting: building footprints; parking areas; vehicle and pedestrian circulation; lighting; landscaping; signage; and licensed premises location.
 Building plans to scale depicting: floor plans indicating the location of sales and service areas; building elevations (photographs are acceptable).
 Photographs of premises from each street frontage that include and show relationship to adjacent structures and the premises visible street address number. Elevations attached *aw*
 Narrative: explaining the project; construction, operation schedule, and open for business target date.
N/A Copy of a zoning map showing the proposed location.
 Copy of completed Alcoholic Beverage Control Board liquor license application form including all drawings and attachments, if filed with ABC Board.
- Optional: N/A Traffic impact analysis N/A Economic impact analysis N/A Noise impact analysis

PROPERTY OWNER AUTHORIZATION* (if petitioner is not property owner)

(1)(WE) hereby grant permission to and acknowledge that person shown as the petitioner on this application is applying for a conditional use **Amended** permit for the retail sales of alcoholic beverages on a property under (MY)(OUR) ownership and that as part of the conditional use permit process the Assembly may apply conditions which will be (MY)(OUR) responsibility to satisfy.

Date 4/28/06 Signature FATHERS, INC. BY: [Signature]

*Report additional petitioners or disclose other co-owners on supplemental form. Failure to divulge other beneficial interest owners may delay processing of this application.

FACILITY OPERATIONAL INFORMATION

What is the proposed or existing business name (Provide both if name is changing):

Chuck E. Cheese's

What is the gross leaseable floor space in square feet?

appx 18000 sf

What is the facility occupant capacity?

825

What is the number of fixed seats(booth and non movable seats)?

53 booths on 1st floor; 26 booths on 2nd floor

What is the number non-fixed seats(movable chairs, stools, etc.)?

120 chairs on 1st floor; 78 chairs on 2nd floor

What will be the normal business hours of operation?

Sunday- Thursday 9am to 10 pm; Fri & Sat 9am to 11pm

What will be the business hours that alcoholic beverages will be sold or dispensed?

Same as above

What do you estimate the ratio of food sales to alcohol beverage sales will be?

% Alcoholic beverage sales **estimate 2-3% of gross sales**

% Food sales **2005 food sales were 64% of total revenues**

Type of entertainment proposed: (Mark all that apply) **family games and kiddie rides**

Recorded music Live music Floor shows Patron dancing Sporting events Other None

Do you propose entertainment or environmental conditions in the facility that will meet the definition of "indecent material" or "adult entertainment" as set forth by AMC 8.05.420 Minors -Disseminating indecent material or AMC

10.40.050 Adult oriented establishment? Yes No

DISTANCE FROM CHURCHES, DAY CARE, AND SCHOOLS

Locate and provide the names and address of all churches, day care, and public or private schools within 200 feet of the site property lines

Name	Address
Family Partnership Charter School	3339 Fairbanks Street, Anchorage, AK (.4 miles)
New Hope Last Frontier & Life Church	1220 E. Street, Anchorage, AK (1.5 miles)

PACKAGE STORES

Provide the projected percentage of alcoholic product inventory in the store where the retail unit price is:

% less than \$5.00	
% \$5.00 to \$10.00	N/A <i>aw</i>
% \$10.00 to \$25.00	
% greater than \$25.00	

CONDITIONAL USE STANDARDS

The Assembly may only approve the conditional use if it finds that all of the following 4 standards are satisfied. Each standard must have a response in as much detail as it takes to explain how your project satisfies the standard. The burden of proof rests with you. Use additional paper if needed.

Explain how the proposed conditional use furthers the goals and policies of the comprehensive development plan and conforms to the comprehensive development plan in the manner required by AMC 21.05.

Amendment to existing CUP only

This project will comply with land use regulations

Explain how the proposed conditional use conforms to the standards for that use in this title and regulations promulgated under this title.

Chuck E. Cheese's originally opened in 1982 under a franchisee owner.
CEC Entertainment, Inc. (franchisor) acquired the location from the franchisee in January 2005

Explain how the proposed conditional use will be compatible with existing and planned land uses in the surrounding neighborhood and with the intent of its use district.

This Amendment will comply with existing and planned land use.

Explain how the proposed conditional use will not have a permanent negative impact on the items listed below substantially greater than that anticipated from permitted development:

1. Pedestrian and vehicular traffic circulation and safety.

No changes. CUP Amendment only

2. The demand for and availability of public services and facilities.

No changes. CUP Amendment only

3. Noise, air, water or other forms of environmental pollution.

No changes. CUP Amendment only

4. The maintenance of compatible and efficient development patterns and land use intensities.

No changes. CUP Amendment only

STANDARDS CHAPTER 10.50 ALCOHOLIC BEVERAGES

In the exercise of its powers and under AS 04.11.480 and 15 AAC 104.145 to protest issue, renewal and transfer or alcoholic beverage licenses within the Municipality of Anchorage, the Assembly shall consider whether the proposed license meets each and every factor and standard set forth below.

Concentration and land use. Whether transfer of location or issue of the requested license will negatively impact the community through an increase in the concentration of uses involving the sale or service of alcoholic beverages within the area affected and will conform to the separate standards of AMC 21.50.020.

How many active liquor licenses are located on the same property as your proposed license?

Within 1,000 feet of your site are how many active liquor licenses?

How would you rate this area's license concentration on a scale of 1 to 5 with 5 = high

How many active liquor licenses are within the boundaries of the local community council?

In your opinion, is this quantity of licenses a negative impact on the local community?

N/A-CUP Amendment only

Training. If application is made for issue, renewal or transfer of a beverage dispensary license, restaurant or eating place license, or package store license, whether the applicant can demonstrate prospective or continued compliance with a Liquor "Server Awareness Training Program approved by the State of Alaska Alcoholic Beverage Control Board, such as or similar to the program for techniques in alcohol management (T.A.M.). Until such plan is approved, training by a licensee's employees in the T.A.M. shall constitute compliance with this ordinance.

How many employees in direct contact with alcohol will be trained in accordance with the Alcoholic Beverage Control Board's Liquor Server Awareness Training Program ?

All employees must complete Chuck E. Cheese's Responsible Alcohol Service Program (a copy of training brochure is attached). In addition, all employees that will be involved in alcohol sales will be over 21 years of age and will be required to take a T.A.M. class.

Operations procedures. If application is made for issue, renewal, or transfer of a license, whether the applicant can demonstrate prospective or continued compliance with operations procedures for licensed premises set forth in Section 10.50.035 of this code. **Please see attached Operations Statement of Chuck E. Cheese's**

- Yes No Happy hours?
- Yes No Games or contests that include consumption of alcoholic beverages? To be posted
- Yes No Patron access and assistance to public transportation?
- Yes No Notice of penalties for driving while intoxicated posted or will be posted? *aw*
- Yes No Non-alcoholic drinks available to patrons?
- Yes No Solicitation or encouragement of alcoholic beverage consumption?

Public safety. When application is made for the renewal or transfer of location or transfer of ownership of a beverage dispensary license restaurant or eating place license, or package store license, the Assembly shall consider whether the operator can demonstrate the ability to maintain order and prevent unlawful conduct in a licensed premises. In determining the operator's demonstrated ability to maintain order and prevent unlawful conduct, the Assembly may consider police reports, testimony presented before the Assembly, written comments submitted prior to or during the public hearing, or other evidence deemed to be reliable and relevant to the purpose of this subsection. For purposes of this section and Section 10.50.035 "licensed premises" shall include any adjacent area under the control or management of the licensee.

What are the proposed precautions to *maintain order* and prevent unlawful conduct at the licensed premises?

inside facility:

Pursuant to corporate policies, CEC only serves one alcoholic beverage per person with ID per trip to order counter. Beer and Wine is served by the glass, no pitchers. No advertising of alcohol sales. Beer and Wine are served in clear plastic glasses (soft drinks in logo cups)

outside facility:

No changes

Payment of taxes and debts. When application is made for renewal of a license the assembly shall consider, pursuant to AS 4.11.330, whether the applicant is delinquent in payment of taxes owed to the Municipality. When application is made for transfer of ownership of a license the Assembly shall consider, pursuant to AS 4.11.360, whether the municipality has received either payment or adequate security, for the payment of any debts or taxes, including any estimated taxes for the current year, arising from the conduct of the licensed business. Adequate security" for the payment of debts and taxes may be in the form of: 1) escrowed funds sufficient to Pay the debts and taxes claimed and any escrow fees; 2) actual payment of debts and taxes claimed; or, 3) a guarantee agreement in accordance AMC 10.50.030. Any guarantee agreement shall be in writing. signed by the transferor, transferee and Municipality

- Yes No Are real estate *and business property* taxes current?
 Yes No Are there any other *debts* owed to the Municipality of Anchorage?

Public health. If application is made for the renewal or transfer of location or transfer of ownership of a license, the Assembly shall consider whether the operator has engaged in a pattern of practices injurious to public health or safety, such as providing alcohol to minors or intoxicated persons, committing serious violations of State law relevant to public health or safety, or other actions within the knowledge and control of the operator which place the public health or safety at risk. In determining if a pattern of practices injurious to public health or safety exists, the Assembly may consider criminal convictions, credible proof of illegal activity even if not prosecuted, police reports, testimony presented before the Assembly, written comments submitted prior to or during the public hearing, or other evidence deemed to be reliable and relevant to the purpose of this subsection.

- Yes No As the applicant *and operator can you comply? If no explain*

**CHUCK E. CHEESE'S #589
308 E. NORTHERN LIGHTS BOULEVARD
ANCHORAGE, ALASKA 99503**

**Information and copies regarding Liquor License Application (Jan 2005)
and Waiver of Operation until after the planned remodel**

aw

CAROLYN Y. HEYMAN-LAYNE
(907) 257-7870
heyman.carolyn@dorsey.com

November 10, 2005

HAND-DELIVERED

Dawn Holland-Williams
Licensing Supervisor
State of Alaska
Alcoholic Beverage Control Board
5848 E. Tudor Road
Anchorage, Alaska 99507

Re: Waiver of Operation Application for C & A Restaurants Inc. License #1744

Dear Dawn:

Enclosed is CEC Entertainment, Inc.'s ("CEC") (d/b/a Check E. Cheese's) second Waiver of Operation Application for 2005 for Restaurant and Eating Place License #1744, located at 308 E. Northern Lights Boulevard in Anchorage. Also enclosed is a check in the amount of \$600 to pay the waiver fee.

Please recall that C & A Restaurants, Inc. ("C & A") was operating this license under a waiver in 2004 following the death of the sole stockholder and primary manager. CEC is the new owner of this establishment, having purchased it from C & A on January 2, 2005. The transfer of this liquor license (No. 1744) to CEC received provisional approval from the ABC Board on July 13, 2005.

CEC requests that this waiver application be placed on the agenda for the ABC Board's November 22, 2005, meeting. If you have any questions regarding this application please contact myself or Bryce Roseman (257-7851).

Sincerely,



Carolyn Y. Heyman-Layne

Enclosures

cc: Alice Winters ✓

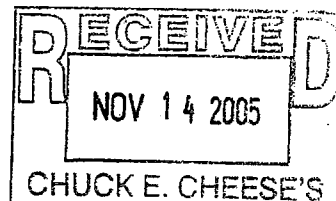

Alcoholic Beverage Control Board
 5848 E Tudor Rd
 Anchorage, Alaska 99507
 (907) 269-0350
 FAX (907) 272-9412

Waiver of Operation Application

AS 04.11.330(a)(3)
15 AAC 104.170

License Information		Fees*	
Liquor License Number: 1744		Waiver Fee	\$600.00
License Type: Restaurant			
Local Governing Body: (City, Borough or Unorganized) Municipality of Anchorage		Penalty (If applicable)	
		Total Submitted	\$600.00
Name of Licensee: CEC Entertainment, Inc.		*The fee is non-refundable [15 AAC 104.170(c)]	
Doing Business As (Business Name): Chuck E. Cheese's		Telephone Number: 972-258-5523	
Mailing Address: CEC Entertainment, Inc. c/o Alice Winters 4441 West Airport Freeway Irving, TX 75062		Street Address or Location of Business: 308 E. Northern Lights Blvd.	
		City: Anchorage	

Waiver Request Information	
This waiver application is the: <input type="checkbox"/> 1 st Request <input checked="" type="checkbox"/> 2 nd Request <input type="checkbox"/> 3 rd Request <input type="checkbox"/> Other _____	
Waiver Request for Calendar Year: 2005	Is this license for sale? <input type="checkbox"/> Yes <input checked="" type="checkbox"/> No

Explanation of the circumstances for non-operation of license. Include relevant information as to why the license was not operated, any future plans for operating the license and projected timelines. Attach additional sheets if necessary.

C & A Restaurants, Inc. ("C & A") was operating this license under a waiver in 2004 following the death of the sole stockholder and primary manager. CEC Entertainment, Inc. ("CEC") is the new owner of this establishment, having purchased from C & A on January 2, 2005. The transfer of this liquor license (No. 1744) to CEC received provisional approval from the ABC Board on July 13, 2005.

CEC Entertainment, Inc. is currently in the process of remodeling the location, including some areas affecting food and alcohol sales. It is CEC's position that in order to ensure safe and appropriate alcohol sales, this location should continue to suspend alcohol sales until the remodeling is complete. The exact date of completion is unknown at this time, but it is unlikely that it will be before the end of 2005. Therefore, the requested waiver will be necessary for the year 2005. It is expected that the remodeling will be complete in the first half of 2006 and CEC will operate under the license at that time.

Signature of Licensee(s)	
Signature CEC ENTERTAINMENT, INC. By: <i>Alice Winters</i>	Signature
Name (Please Print) Alice Winters	Name (Please Print)
Date Nov 9, 2005	Date

State of Alaska
Alcoholic Beverage Control Board
November 22, 2005
Agenda

All Board members present - Mike Gordon, Gail Niemi, William Tull, Shirley Gifford – present in person; Billy Andrews present via teleconference. All votes voiced separately.

1. ADMINISTRATION

A. Approve Board minutes of July 13, 2005 and September 29, 2005.

Approved 3-0 (Billy was not present for this vote; Shirley was not present for these two meetings.)

B. Delegate to the Director tie-breaking vote.

Approved 4-0 (Billy was not present for this vote)

2. ADMINISTRATIVE MATTERS

A. INFORMAL CONFERENCES

B. HEARING OFFICER DECISIONS

1. 04/05-56 American Legion Post #13; American Legion Post #13; located at 205 Lincoln St in Sitka; club license.

Failure to reach settlement after Hearing Officer Decision.

Attachment 2B-1

Approved 5-0 with change to language: December 1, 2005 thru December 1, 2006 (~~November 1, 2005 thru November 1, 2006~~)

C. SETTLEMENT AGREEMENT

1. 04/05-2658 American Legion Post #15; American Legion Mat-Su Valley Post #15; located at Lot 2 Woods McLeod Lake Sbdv in MatSu Borough; club license.

Informal settlement of Accusation # 05-07

Attachment 2C-1

Approved 5-0

D. VOLUNTARY RELINQUISHMENT OF LICENSE

1. 04/05-3697 Old Town Village Restaurant; PM & SJ Voszar and RW & LS Strawn; located at 1000 Mission Ave #100 in Kenai; restaurant/eating place license.

Voluntary relinquishment.

Attachment 2D-1

Read into record

2. REMOVED

N. 04/05-119 Big Lake Lodge; Loon's Landing Inc.; located at 151 W Big Lake Lodge Rd in MatSu Borough; beverage dispensary license; waiver of operation.

1st request 2005 Fees Paid

Attachment 3N

O. 05/06-1744 Chuck E. Cheese's; CEC Entertainment, Inc.; located at 308 E Northern Lights Blvd in Anchorage; beverage dispensary license; waiver of operation.

2nd request 2005 Fees Paid

Attachment 3O

P. 04/05-4011 Seven Seas Navigator; Radisson Seven Seas, Inc.; located in Alaskan Waters; common carrier license; waiver of operation.

2nd request 2005 Fees Paid

Attachment 3P

Q. 04/05-859 Wylie Coyote; AOK Inc.; located at 2421 E Tudor Rd in Anchorage; beverage dispensary license; waiver of operation.

2nd request 2005 Fees Paid

Attachment 3Q

END CONSENT AGENDA

This application is for:

- Seasonal - Two 6-month periods in each year of the biennial period beginning _____ and ending _____
 Full 2-year period _____ Mo/Day _____ Mo/Day

Type of Application: Transfer of Ownership Relocation Establishment Name

SECTION A. LICENSE INFORMATION: Must be completed for all types of applications.			FEES		
Current License # 1744	License Type: Restaurant/Eating place	Filing Fee: \$100.00			
License Year 2005 / 2006	Local Governing Body: (City, Borough or Unorganized) Municipality of Anchorage	Total Submitted: \$1,100.00			
Statute Reference Sec. 04.11.	Applicant's/transferee's name as it should appear on the license: CEC Entertainment, Inc.	Community Council Name(s) & Mailing Address (if applicable)			
Bus. Tel. # 972/258-5523	Applicant's/transferee's mailing address: 4441 West Airport Freeway, Irving, TX 75062	See Attachment A			
Fax # - 972/258-5534	Doing Business As (Business Name) Chuck E. Cheese's				
Federal FIN: 48-090-5805	Street Address or Location of Business 308 E. Northern Lights Blvd				City Anchorage
Email Address awinters@cecentertainment.com					
SECTION B. PREMISES TO BE LICENSED. Must be completed for Relocation applications.					
Name to be used on public sign or advertising: Chuck E. Cheese's		<input type="checkbox"/> Premises is GREATER than 50 miles from the boundaries of an incorporated city, borough, or unified municipality. <input type="checkbox"/> Premises is LESS than 50 miles from the boundaries of an incorporated city, borough, or unified municipality. <input type="checkbox"/> Not applicable <input type="checkbox"/> Plans submitted to Fire Marshall (required for new & proposed buildings) <input checked="" type="checkbox"/> Diagram of premises attached			
Closest school grounds: See Attachment A					
Closest church: See Attachment A					
Distance measured under:	<input checked="" type="checkbox"/> AS 04.11.410 OR <input type="checkbox"/> Local ordinance No.				
Premises to be licensed is:	<input checked="" type="checkbox"/> Existing facility <input type="checkbox"/> New building <input type="checkbox"/> Proposed building				
SECTION C. TRANSFER INFORMATION.					
<input checked="" type="checkbox"/> Regular Transfer		Name and Mailing Address of Current Licensee C & A Restaurants, Inc. 2648 S. Higbee Idaho Falls, Idaho 83404			
<input type="checkbox"/> Transfer with security interest: Any instrument executed under AS 04.11.670 for purposes of applying AS 04.11.360(4)(b) in a later involuntary transfer, must be filed with this Application (15 AAC 104.107). Real or personal property conveyed with this transfer must be described. Provide security interest documents.		Business Name (dba) BEFORE transfer Chuck E. Cheese's			
<input type="checkbox"/> Involuntary Transfer. Attach documents which evidence default under AS 04.11.670.		Street Address or Location BEFORE transfer 308 E. Northern Lights Blvd			
SECTION D. Individual, corporate officer, director, limited liability organization member, manager or partner background.					
Does any individual, corporate officer, director, or limited liability organization member, manager or partner named in this application have any direct or indirect interest in any other alcoholic beverage business licensed in Alaska or any other state?					
<input checked="" type="checkbox"/> Yes <input type="checkbox"/> No If Yes, complete the following. Attach additional sheets if necessary.					
Name	Name of Business	Type of License	Business Street Address	State	
CEC Entertainment, Inc. owns and operates 443 Chuck E. Cheese's in 43 states, most of which have some type of liquor license.					
This is the first Alaska location of CEC Entertainment, Inc.					
Has any individual, corporate officer, director, limited liability organization member, manager or partner named in this application been convicted of a felony, a violation of AS 04, or been convicted as a licensee or manager of licensed premises in another state of the liquor laws of that state?					
<input type="checkbox"/> Yes <input checked="" type="checkbox"/> No If Yes, attach written explanation					

License Number	Date Approved	Director's Signature

Alcoholic Beverage Control Board
 5848 E Tudor Rd
 Anchorage, AK 99507
 http://www.dps.state.ak.us/abc/

Liquor License Transf

(907) 269-0350
 Fax: (907) 272-9412

This application is for:

- Seasonal - Two 6-month periods in each year of the biennial period beginning _____ and ending _____
 Mo/Day Mo/Day
- Full 2-year period

Type of Application: Transfer of Ownership Relocation Establishment Name

Corporations must be registered with the Alaska Department of Community and Economic Development. (DCED)

Name of Corporation: CEC Entertainment, Inc.		Telephone Number: 972/258-5523	Fax Number: 972/258-5534
Corporate Mailing Address: 4441 West Airport Freeway,		City: Irving,	State: TX
		Zip Code: 75062	
Name, mailing address & telephone number of registered agent: Corporation Service Co, 801 W. 10th Street, Suite 300 Juneau, AK 99801		Date of Incorporation or Certificate of Authority: 4/30/80	State of Incorporation: Kansas
Is the corporation in compliance with the reporting requirements of Title 10 of the Alaska Statutes? <input checked="" type="checkbox"/> Yes <input type="checkbox"/> No If no, attach written explanation.			
Corporate Officers (Must include President, Secretary and Treasurer, and Vice-President if applicable)			
Name	Title	* if Director	Home Address & Telephone Number
Please see attached list of corporate officers.			
Corporate Directors & Stockholders with a 10% or more interest. Attach additional sheets if necessary.			
Name	Home Address	Telephone #	Percentage (%) of shares
Please see attached list of corporate directors.			
CEC Entertainment, Inc. is a public company traded on the New York Stock Exchange under the symbol "CEC" Please see attached list of Stockholders			
Note: On a separate sheet provide information on ownership of other organized entities that are shareholders of the licensee.			
Declaration			
<ul style="list-style-type: none"> I declare under penalty of perjury that I have examined this application, including the accompanying schedules and statements, and to the best of my knowledge and belief it is true, correct and complete, and this application is not in violation of any security interest or other contracted obligations. The undersigned certifies on behalf of the corporation, it is understood that a misrepresentation of fact is cause for rejection of this application or revocation of any license issued. I further certify that I have read and am familiar with Title 4 of the Alaska statutes and its regulations, and that in accordance with AS 04.11.450, no person other than the licensee(s) has any direct or indirect financial interest in the licensed business. I agree to provide all information required by the Alcoholic Beverage Control Board in support of this application. 			
SIGNATURE OF CURRENT LICENSEE(S)		SIGNATURE OF TRANSFEREE(S)	
Signature C & A Restaurants, Inc.		Signature CEC Entertainment, Inc.	
BY: <i>[Signature]</i>		BY: <i>[Signature]</i>	
Name & Title (Please Print) Travis Caudle, President		Name & Title (Please Print) Alice Winters, Ass't Sec/Ass't Treas.	
Subscribed and sworn to before this <u>20</u> day of <u>January</u> 2005		Subscribed and sworn to before this <u>10th</u> day of <u>January</u> , 2005	
Notary public in and for the State of Idaho <i>[Signature]</i>		Notary public in and for the State of Texas <i>[Signature]</i>	
My Commission expires: <u>12-22-09</u>		My Commission expires: <u>8-19-2006</u>	



CHERI M. HIRSCH
 Notary Public, State of Texas
 My Commission Exp. 08-19-2006

**ATTACHMENT A TO CEC ENTERTAINMENT, INC.'S APPLICATION FOR
TRANSFER OF RESTAURANT/EATING PLACE LIQUOR LICENSE #1744**

Community Council: Names & Mailing Addresses	Midtown Community Council c/o Michael Olson 3386 Mt. Vernon Court Anchorage, Alaska 99503 molson@acsalaska.net
	Rogers Park Community Council c/o Peter Mjos 1725 E. 24 th Ave. Anchorage, Alaska 99508 torsk@alaska.net
	North Star Community Council c/o Barb Pepek 1331 Hillcrest Dr. Anchorage, Alaska 99503 NSCCchair@yahoo.com
Closest School Grounds:	Family Partnership Charter School (.4 mile)
Closest Church	New Hope Last Frontier and Life (1.13 miles)

**CEC ENTERTAINMENT, INC.
OFFICERS**

NAME	RESIDENCE ADDRESS	RESIDENCE TELEPHONE	DATE OF BIRTH	PLACE OF BIRTH	CITIZENSHIP	SOCIAL SECURITY	DRIVERS LICENSE
Richard M. Frank CEO & Director	4923 DeLoache Ave. Dallas, TX 75220	469/232-0172	01/26/48	Hornell New York	U.S.	096-38-0235	11107686/TX
Michael H. Magusiak President & Director	5300 Burgandy Ct. Colleyville, TX 76034 (4YRS)	817/571-3872	03/29/56	Warren Ohio	U.S.	269-60-9104	12352648/TX
Marshall R. Fisco, Jr. Vice President/Secretary	3227 McKinney Ave.#22-F Dallas, TX 75205 (10YRS)	214/954-0157	12/02/58	New Haven Connecticut	U.S.	044-62-5519	12132704/TX
James Mabry Vice President /Treasurer	809 Sequoia Lane Keller, TX 76248 (4YRS)	817/431-2362	10/22/49	Greenville, Texas	U.S.	459-80-5755	05775819/TX
Alice Winters Asst. Sec./Asst. Treas.	403 Dakota Trail Irving, TX 75063 (11YRS)	972/444-0139	08/30/39	Lamar Colorado	U.S.	522-46-2135	11989845/TX

1/7/05

CEC ENTERTAINMENT, INC.
DIRECTORS

NAME	RESIDENCE ADDRESS	RESIDENCE TELEPHONE	DATE OF BIRTH	PLACE OF BIRTH	CITIZENSHIP	SOCIAL SECURITY NUMBER	DRIVERS LICENSE NUMBER
Richard M. Frank CEO & Director	4923 DeLoache Ave. Dallas, TX 75220	469/232-0172	01/26/48	Hornell New York	U.S.	096-38-0235	11107686/TX
Michael H. Magusiak President & Director	5300 Burgandy Ct. Colleyville, TX 76034	817/571-3872	03/29/56	Warren Ohio	U.S.	269-60-9104	12352648/TX
Richard T. Huston Exec. V.P. & Director	152 Shepherds Glen Heath, TX. 75032	972/771-0408	01/18/46	Chicago Illinois	U.S.	353-36-4691	09099687/TX
Raymond E. Wooldridge Director	7808 Glenshannon Cr. Dallas, Tx 75225	214/750-1887	10/20/38	Ponca City Oklahoma	U.S.	441-38-2182	06096178/TX
Walter W. Tyree Director	15 Lyric Arbor Circle The Woodlands, Tx 77381	409/321-5616	11/11/51	Welch W. Virginia	U.S.	290-50-4884	08456551/TX
Tim T. Morris Director	9006 Rocky Point Rd Chattanooga, TN 37379	423/842-2615	09/17/46	Chattanooga Tennessee	U.S.	411-74-8475	28553385/TN
Louis P. Neeb Director	6914 Hillpark Dr. Dallas, Tx 75230	972/934-1928	04/14/39	Ft. Wayne Indiana	U.S.	309-42-1028	01720139/TX
Cynthia Pharr Lee Director	5004 Morris Ave. Addison, TX 75001	972/931-7376	10/26/48	Laurel Mississippi	U.S.	587-36-1807	07331536/TX

REV. 1/7/05

OFFICER.DIR/DOC/KRC

CEC ENTERTAINMENT, INC.
 a Kansas Corporation
 Stockholder Information
 July 29, 2004

**PRINCIPAL HOLDERS OF RECORD OWNING 5% OR MORE
 OUTSTANDING COMMON AND PREFERRED STOCK**

NAME AND ADDRESS	FED. I.D. NUMBER	SHARES OF STOCK	PERCENTAGE OF STOCK
------------------	------------------	--------------------	---------------------

COMMON AND PREFERRED STOCK:

100,000,000 shares of Common Stock authorized, par value \$0.10; 35,620,966 shares issued; 25,745,412 shares outstanding; NYSE "CEC". 500,000 shares of Class "B" Preferred Stock authorized, par value \$100.00; no shares issued.

FMR Corp. 82 Devonshire Street Boston, MA 02109	16-1144965	<u>Common Stock</u> 5,816,250	10.10% ¹
Neuberger Berman, Inc. 605 Third Avenue New York, New York 10158	06-1523639	4,340,071	10.87% ²
T. Rowe Price Associates, Inc. 100 East Pratt Street Baltimore, MD 21202	52-0556948	3,532,725	5.87% ³
Richard M. Frank Chairman of the Board and Chief Executive Officer 4441 West Airport Freeway Irving, Texas 75062	096-38-0235	238,528	0.85% ⁴

1. Based upon information in Schedule 13G dated February 16, 2004, and adjusted to reflect a 3-for-2 stock split in the Common Stock of the Company on March 15, 2004..
2. Based upon information in Schedule 13G dated February 13, 2004, and adjusted to reflect a 3-for-2 stock split in the Common Stock of the Company on March 15, 2004.
3. Based upon information in Schedule 13G dated February 13, 2004, and adjusted to reflect a 3-for-2 stock split in the Common Stock of the Company on March 15, 2004.
4. Based on Form 4 dated July 22, 2004 (all shares being owned indirectly through Trusts). Although Mr. Frank's stock ownership is less than 5% of the outstanding stock, his ownership interest is included because of his positions as the Chairman of the Board and Chief Executive Officer.

STATE OF ALASKA
ALCOHOLIC BEVERAGE CONTROL BOARD

AFFIDAVIT IN CONNECTION WITH POSTING LIQUOR LICENSE APPLICATION
Section 04.11.260, 04.11.310, & AAC 104.125 Alaska Statutes, Title 4

POSTING AFFIDAVIT

I, the undersigned, being first duly sworn on oath, depose and say that:

1. a. Posting of application for a new _____ liquor license
for _____
located at _____
(address and/or location)

OR

- b. Posting of application for transfer of a Restaraunt/eating place liquor license
currently issued to C&A Restaurants, Inc. whose business name (d/b/a)
is Chuck E. Cheese's located at 308 E. Northern Lights Boulevard, Anchorage
(address and/or location)

2. Has been completed by me for the following 10 FULL day period:

February 13, 2005 to February 23, 2005

*** Prior to the filing of said application, a true copy of the application was posted at the following described locations: (name and address of location)

- a. Location of premises to be licensed Chuck E. Cheese's, 308 E. Northern Light Blvd., Anchorage
b. Other conspicuous location in the area Midtown Post Office, 3720 Barrow St., Anchorage
3. I believe that with the approval of this application population would not at one time exceed in the aggregate of one license of the type requested for population as provided by law. AS 04.11.400 (check one)
- a. a radius of five (5) miles of the proposed location.
b. an incorporated city, organized borough or unified municipality.
c. does not apply (application filed under AS 04.11.400(d)(e)(g) or transfer of license holder or location within an incorporated city or unified municipality or organized borough).
d. established village.

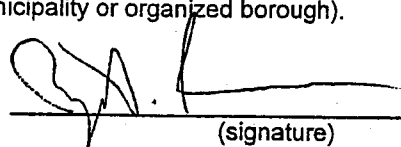

(signature)

SUBSCRIBED and SWORN to me this 28th day of February, 2005.

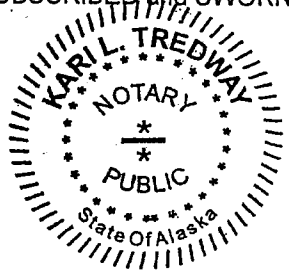

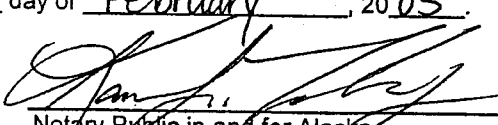

Notary Public in and for Alaska
My commission expires: 8-15-07

ANCHORAGE PUBLISHING, INC.

Mail: P.O. Box 241841, Anchorage, Alaska 99524-1841
Office: 540 E. Fifth Avenue, Anchorage, Alaska 99501
Phone: (907) 561-7737 Fax: (907) 561-7777

ANCHORAGE PRESS AFFIDAVIT OF PUBLICATION

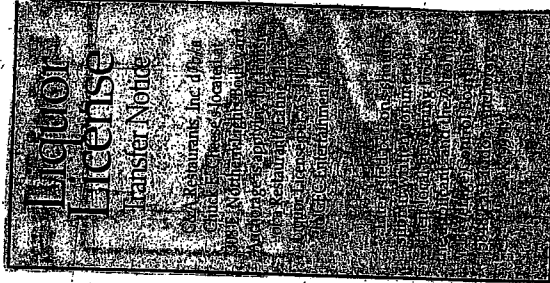

I, Jill Tillion, advertising representative for Anchorage Publishing, Inc., verify that the Liquor License Transfer Notice C & A Restaurants, Inc. d/b/a Chuck E. Cheese's located at 308 E. Northern Lights Boulevard, Anchorage was published in the February 3, 10, and 17, 2005 issues of the Anchorage Press Newspaper.

Jill Tillion

Subscribed and sworn to me in the Municipality of Anchorage, in the state of Alaska, on this 25 day of February, 2005.

Notary Public Signature

Notary Public Seal:

January 21 2009
Commission Expires

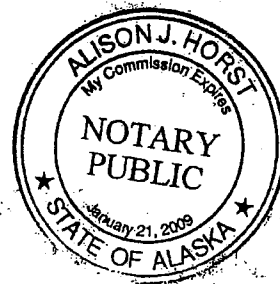

CHUCK E. CHEESE'S

OPERATION STATEMENT

CEC ENTERTAINMENT, INC.

CHUCK E. CHEESE'S RESTAURANTS

COMPANY OPERATED 465 in 43 states
 13 in Canada

FRANCHISED 45

523 Total in 47 States & Canada

PUBLICLY TRADED COMPANY

(NYSE) National Market System "CEC"

2005 Revenues in excess of \$700,000,000.

CEC ENTERTAINMENT, INC.

TYPE OF OPERATION

CEC Entertainment, Inc. owns and operates the Chuck E. Cheese's pizza restaurants. This is a pizza restaurant and family entertainment center, serving lunch and dinner. The menu includes pizza, sandwiches, salad bar, soft drinks, beer and wine. For family entertainment, the restaurant offers kiddie rides, arcade games, skill games, video-skill games and a computer controlled animated character, which sing songs and tell jokes and stories. The restaurant will have 80 to 100 coin operated games and rides, most of which will be ticket – dispensing.

HOURS OF OPERATION

(Hours may vary in some areas)

Sunday through Thursday from 9:00 AM to 10:00 PM (8:00 AM if breakfast is served)

Friday & Saturday from 9:00 AM to 11:00 PM (8:00 AM if breakfast is served)

Peak hours of operation are Friday evenings and weekends

CLIENTELE

Chuck E. Cheese's restaurants are family oriented. Our operation is geared to appeal to families with children 1 to 11 years of age. Children under 18 are not allowed into the facility unless they are accompanied by a parent or guardian. A large part of our business is catering children's birthday parties.

STAFFING

The restaurants will employ two (2) to five (5) managers and one (1) technician plus approximately forty (40) to sixty (60) hourly employees. During all hours of operation, at least one manager is on duty. At all times, there is a manager on duty who is at least 21 years of age.

EQUIPMENT & SPECIAL FEATURES

The facility utilizes kitchen and cooking equipment, tables, booths and dispersing equipment in connection with food and beverage service. There is an area devoted to children with kiddie rides and free play elements. There is a family area with arcade/skill games, and a dining room with a computer controlled animated character performing at set intervals from a stage area. There is also a small gift shop area in the restaurant.

OUR BUSINESS

A restaurant and entertainment center for families with kids under 12.

- * 98% awareness
- * About 50% present customers
- * 96% customers bring kids under 12
- * 80% have kids under 6
- * Average kid age 5.4 years

Average group size (non party) 2.5 kids + 1.9 adults for a total of 4.4 people per group.
Birthday Parties are approximately 15% of total revenues.

REVENUES

- * 60% to 70% food and beverage
- * 30% to 40% rides and games
- * 2% to 4% merchandise

MENU

- * Pizza
- * Sandwiches
- * Salad Bar
- * Dessert
- * Soft drinks
- * Beer and Wine

LOCAL EMPLOYEES

LOCAL RESTAURANT MANAGEMENT

LOCAL DISTRICT AND REGIONAL SUPERVISORS

KEY CONSUMER BENEFITS

- * Food and Beverage
- * Rides (coin operated)
- * Games (coin operated)
- * Animated Show
- * Tickets/prizes
- * Kiddie free play elements
- * Walk around character

BEER & WINE

Beer and wine sales are less than 5% of gross sales.

Our surveys show that 20% to 25% of the adults are having a glass of beer or wine with their pizza.

We serve it as an accommodation and because our adult guests request it.

Served by glass – no pitchers

Beer sales are low profile – no advertising

Beer glasses – clear plastic 12 oz. and 20 oz.

Wine glasses – clear plastic – 8 oz.

**ONE ALCOHOLIC BEVERAGE PER PERSON WITH ID
PER TRIP TO ORDER COUNTER**



RESPONSIBLE ALCOHOL SERVICE

August 2001



TABLE OF CONTENTS

I.	Introduction	
	- Pre-test	16-17
	- Alcohol Awareness Overview	18
	- Background	19
II.	Server and Licensee Liability	19
	- Dram Shop/Third Party Liquor Liability	20-21
	- Legal Age to Serve	22
III.	Minors and Identification	23
	- Acceptable Forms	24
	- Checking ID's	24
	- Cashier Training/F.L.A.G. System	25
IV.	Intoxication	
	- What is the legal limit?	26
	- Facts	27
V.	Handling Problems	
	- Avoiding and Monitoring	28
	- Intervention Scenarios	28-29
	- Guest Safety	30
	- Helpful Hints	31
VI.	Responsible Alcohol Service Training Acknowledgement	33



RESPONSIBLE ALCOHOL SERVICE KNOWLEDGE TEST

1. The Dram Shop Act imposes civil liability upon the server of alcohol when an intoxicated person causes injury or property damages to an innocent third party.

YES
NO

2. A person can become just as intoxicated drinking beer or wine as when drinking distilled spirits.

YES
NO

3. The presence of food in the stomach will slow down the absorption rate of alcohol into the bloodstream.

YES
NO

4. The less a person weighs, the less B.A.C. rises per ounce of alcohol consumed.

YES
NO

5. Conventional wisdom states that at .10% BAC, anyone will exhibit signs of being intoxicated.

YES
NO

6. Servers of alcohol must have an acceptable reason for requesting to see a patron's identification prior to service.

YES
NO

7. Check which of the following are legally acceptable forms of ID.

<input type="checkbox"/> Valid Driver's license	<input type="checkbox"/> School ID
<input type="checkbox"/> Valid State issued ID card	<input type="checkbox"/> Birth Certificate
<input type="checkbox"/> U.S. Passport	<input type="checkbox"/> Social Security Card
<input type="checkbox"/> Military ID Card	<input type="checkbox"/> Expired Driver's License

8. It is illegal to serve someone under _____ years of age.

9. To remain within the safe limits of alcohol consumption, a medium-built person can normally consume _____ drinks during the first hour. The limit after the first hour is _____ drinks per hour.

10. If a guest arrives at our restaurant already intoxicated and we serve him only 1 drink, we are not liable for what happens when he leaves.

YES
NO



RESPONSIBLE ALCOHOL SERVICE ANSWER KEY

1. YES. Servers, managers, and owners may be sued.
2. YES. A 12 oz beer = 4 oz wine = 1 oz of alcohol.
3. YES. But really only helps if eaten before or during alcohol consumption
4. NO. The less they weigh, the more the BAC rises.
5. NO. They will exhibit signs prior to that level.
6. NO. Can request ID regardless of cause.
7. Valid Driver's License, Valid State ID Card, US Passport, Military ID Card. The rest are not valid, even if combined.
8. 21
9. 1-2 the 1st hour; 1 per hour thereafter.
10. NO. We can be held liable since we served an intoxicated person and let him leave.



ALCOHOL AWARENESS OVERVIEW

In most states the restaurant itself can be held liable for the guest's actions if he injures himself or others as a result of becoming intoxicated in our restaurants. This is called the Dram Shop Act (or third party liability). As a corporation we want to limit our liability by training all of our cast members to recognize signs of intoxication and by expecting the management to handle the guest in a way that assures compliance with the local liquor laws.

Our challenge is to manage our restaurants so that we do not contribute to the problem of drunken driving and to establish ourselves, for the long term as a business dedicated to the fun and safety of our guests.

One of the many attractions of our restaurant is atmosphere. The serving of alcohol (beer and wine) is one of the elements, which contributes to that atmosphere and to guest satisfaction. Any successful business seeks to respond to what the guest wants, but a successful business person also needs to deal with relevant issues, which may impact the business.

Increased public concern for alcohol abuse continues to remind us of our role as successful business people. We must not allow our guests to hurt themselves or others by consuming too much alcohol. As managers we must use our judgment and common sense to manage the sales of our beer and wine and to communicate our concern for the welfare of our guest.

Colorado: The victim of a drunk driving accident won \$9.5 million in an out-of-court settlement, not from the driver who caused the accident, but from the establishment who served the driver.

Michigan: A tavern agreed to a settlement of \$10.8 million, including a \$3 million cash payment, to the families of two people killed by a drunk driver who was served at the tavern before the accident.

Ohio: Widows of two men killed in an accident involving alcohol sued a bar and its owner for \$24 million.

The term "third-party liability" is the responsibility an establishment's owners, managers, and employees have in the case of an injury. Although they themselves have not directly caused the injury, they, as the "third-party" may be held liable for contributing to the factors that allowed an injury to happen.

The intent of alcohol awareness training is to provide managers and cast members with a sound, factual basis to make rational business decisions.

We must balance the short-term benefit of the immediate sales with the long term good of our guests continuing to return to us.



BACKGROUND

The reason you are taking this training is that we are concerned about serving alcohol responsibly. We want to obey the law, protect our guests, protect our liquor licenses, reduce accidents caused by intoxicated people, and make your job safer and easier. By actively practicing responsible alcohol service, you can make your guests feel welcome and valued.

Alcohol has a relaxing effect and causes a sense of well-being. There is a feeling of fellowship in enjoying a drink with friends. Alcohol is also associated with taking pleasure in food. Wine, in particular, enhances the flavor of food, making dinner more enjoyable.

Unfortunately, there are those who drink for the wrong reasons or who over consume alcohol. At times, alcohol is not pleasurable. According to the U.S. Department of Transportation National Highway Traffic Safety Administration, drunk driving fatalities involving drivers with a Blood Alcohol Concentration (BAC) of 0.10 percent or greater have decreased since 1982. Still, nearly 18,000 people a year are killed in drunk driving accidents. Not only the drunk driver is at risk. Many of those injured or killed are passengers or innocent bystanders. In addition, alcohol-related crashes are one of the major causes of death in the 16 to 24 year old age group.

Studies show that 37 percent of all alcohol consumed takes place in bars and restaurants, and that 80 percent of alcohol-related crashes involve a BAC of 0.10 percent or higher. The hospitality industry needs to show its awareness of responsible alcohol service. Managers and employees have the opportunity to help reduce traffic injuries and deaths caused by intoxicated drivers.

Traffic accidents are not the only concern regarding alcohol consumption. Intoxicated individuals may become hostile and start fights, causing injury to themselves or others. Due to poor judgment or reduced motor coordination, the person who has over consumed alcohol may fall or be injured accidentally. He/she may accidentally hurt other patrons.

SERVER AND LICENSEE LIABILITY

For one thing, selling alcohol to a minor or intoxicated person is a criminal offense throughout the United States. The potential legal consequence for servers include arrest, fine, jail term, criminal record, and lost of employment. In addition, as the holder of the establishment's liquor permit or license, the licensee will likely be cited and fined by the state's liquor authority. The state also has discretionary power to suspend or revoke an establishment's license, effectively closing its doors.

Selling alcoholic beverages to an underage or obviously intoxicated person are not the only acts that create legal liability. A licensee also has a legal responsibility to ensure the safety and welfare of the establishment's clientele and can be held civilly and administratively liable for incidents occurring on the licensed property that result in bodily injury or property damage.



DRAM SHOP LAWS (Third Party Liquor Liability)

The Servers, Managers, and The Company can be liable for a guest's actions if he/she injures him/herself or another party as a result of becoming intoxicated in our restaurants.

The most prevalent type of liquor liability lawsuit is brought by an innocent "third party" injured in some manner by an intoxicated patron (in legal parlance, the "first party" is the person purchasing the alcohol; the "second party" is the person serving the alcohol; the "third party" is someone outside of the particular transaction). In these cases, the plaintiff's attorney will attempt to prove that the patron was served alcohol to the point of intoxication, allowed to leave the establishment in an incapacitated condition and that the alcohol-induced impairment directly caused the ensuing accident. As a result of the employee's negligence, the licensee is culpable and liable for damages sustained by the third party.

A manager may also be named as a defendant in a third party lawsuit based on the liability theory of negligent failure to supervise. The basis for the action stems from the theory that a manager has a duty to "reasonably supervise and monitor" the on-premise activity and the actions of the operation's employees.

The Dram Shop Act encourages businesses to conduct themselves in a responsible manner towards their guests. Some proactive tips to avoid potentially dangerous situations include:

1. Actively encouraging patrons not to become intoxicated if they are consuming alcoholic beverages on the premises.
2. Promoting alternative, non-alcoholic beverages and making food readily available to patrons.
3. Providing an alternative, "safe" means of transportation intended to reduce the incidence of patrons driving while intoxicated.
4. Prohibiting employees from consuming alcoholic beverages while on duty.
5. A comprehensive on-going training program for servers in alcohol awareness, the responsible service of alcohol, and how to effectively interact with intoxicated patrons.



6. Maintaining an adequate number of well-trained employees for the type and size of the establishment.
7. Maintaining a standardized method for screening and hiring qualified employees.
8. Reprimanding and disciplining employees who violate the business's policies and procedures.
9. Establishing a comprehensive on-going training program for servers focusing on methods of detecting a falsified or altered piece of identification tendered for the purpose of purchasing alcoholic beverages.
10. Training servers to carefully examine identification for all persons seeking to purchase alcoholic beverages who may be reasonably suspected of being under-aged.

REVIEW

The 3 types of potential liability are:

- 1) Criminal Liability: Owners, managers, and servers who sell to minors or intoxicated persons could face arrest, fines, and jail.
- 2) Administrative Liability: A.B.C. can fine store or revoke license and employee can be fired.
- 3) Civil Liability: Owners, managers, and servers can be personally sued for the acts committed by intoxicated person served at our restaurants.



LEGAL AGE TO SERVE ALCOHOL

<u>STATE</u>	<u>AGE</u>
Alabama	21
Arkansas	21
California	21
Colorado	21- unsupervised; 18 with absolute supervision by a manager 21 yrs or older in range to hear and see the actions of any cashier selling, serving or pouring.
Connecticut	18 - Deliver Beer/Wine to tables - NO service across order counter. Liquor Inventory must be stored under lock and key.
Delaware	0 - N/A
Florida	18
Georgia	18 - Per State requirement, 21 per Savannah local code.
Idaho	19
Illinois	18 to 21 - Age to serve varies in each restaurant per municipality codes
Indiana	21 - And have an Employee permit
Iowa	18
Kansas	18 - CEC is licensed to <u>ONLY</u> sell 3.2 beer
Kentucky	20
Louisiana	18
Maine	21- unsupervised; 18 with absolute supervision by a manager 21 yrs or older in range to hear and see the actions of any cashier selling, serving or pouring.
Maryland	18 to 21- Depending on county code for beer; 21 for wine
Massachusetts	18
Michigan	18
Minnesota	18 - Blaine requires all <u>Food</u> and <u>Beer/Wine</u> except salad bar to be delivered to tables
Mississippi	21
Missouri	21
Nebraska	19 - with 21 year old Mgr. on premises
Nevada	21
New Hampshire	18
New Jersey	0 - N/A
New Mexico	21
New York	18 - to handle liquor in ANY WAY
North Carolina	18
Ohio	19 - Beer and Wine when acting as waiter - 19yrs old to sell beer across bar. 21yrs old to sell wine across the bar
Oklahoma	18 - CEC is licensed to <u>only</u> serve beer (low point beer)
Pennsylvania	18
Rhode Island	18
S. Carolina	21
S. Dakota	18 - To ID & collect money; 21 to handle liquor
Tennessee	18 - Beer and Wine sales have different requirements
Texas	18
Virginia	18 - If the sale is supervised by someone 21
W. Virginia	21- unsupervised; 18 with absolute supervision by a manager 21 yrs or older in range to hear and see the actions of any cashier selling, serving or pouring.
Washington	18 - To ID & collect money; 21 to handle liquor
<u>Wisconsin</u>	18 - And hold a Bartenders Card
41	
Canada	18 (19 to Drink) - Beer/Wine to be delivered to tables in <u>Showroom</u> only. Except in Edmonton

*As of June 21, 2004



MINORS AND IDENTIFICATION

It is illegal to serve the following types of people.

- Minors
- Intoxicated Individuals
- Known, habitual alcoholics

There is no penalty for refusing to serve someone you suspect is one of the above.

MINORS

It is illegal to serve alcohol to people under 21 years of age. It is very important to follow the procedures established by the Company to avoid the possibility of serving a minor. All employees should learn these procedures and follow them carefully.

It is a very serious violation of the liquor code to serve a minor and the punishment may be severe.

In some states it may be illegal for a minor to buy, or try to buy, alcohol. It may also be illegal for a minor to present a false ID. However, these restrictions vary from state to state. Even if it is not illegal in your area for a minor to present a false ID, or to try to buy alcohol, it is illegal for you to serve a minor. **You will be held accountable, even if the minor is not!**

Once you have been trained to carefully check identification and to detect false I.D.'s, you will be able to handle situations involving minors in a responsible and confident manner. Know our policies regarding minors. Follow the established policies carefully. Don't allow the rules to be bypassed by anyone, whether that be a friend or a special guest.

* An increasing number of states are allowing "Decoy Programs" (underage people trying to buy alcohol) to help catch servers and managers that serve underage guests. Don't let this happen to you! I.D. 'em!

If the Guest is ordering at the cash register, **THE PERSON SERVING THE ALCOHOLIC BEVERAGE** is responsible to ID the Guest. At a party, the Birthday Hostess **MUST** direct the guest to the order counter.



ACCEPTABLE FORMS OF IDENTIFICATION

- Driver's License
- State-issued identification card
- Federal Military I.D. card
- U.S. Passport & Foreign Passport
- In many states it is O.K. to accept only your State's Drivers License

NOTE: If you do accept out-of-state licenses, use an I.D. Checking Guide. Most local beer distributors can provide you an I.D. Checking Guide that has color pictures of all states' licenses and I.D. cards.

If someone does not have a valid I.D., say: "I'm sorry, but I can't serve you without a valid I.D."

CHECKING I.D.'S

- Be familiar with State Licenses and I.D. cards.
- Ask for I.D. from everyone
- Have them remove from wallet or holder.
- Look for State seal.
- Make sure physical description matches person.
- Feel I.D. for alterations that may be passed on.
- Do the Math!! They must be 21. Look them in the eye!
- **CHECK I.D. AS IF YOU WERE CASHING A \$1,000 CHECK, BECAUSE THAT'S WHAT IT MAY COST YOU IF WRONG.**



Some notes about checking I.D.'s:

- Most states will not allow you to combine two pieces of *unacceptable* I.D. to make one *acceptable* I.D.
- Use the **F-L-A-G SYSTEM**.

F = FEEL

- Have person remove the I.D. from their wallet or plastic holder (never accept a laminated document).
- Feel for information cutout or pasted on (especially near photo and birthday areas).
- Feel the texture.

L = LOOK

- Look for the State seals.
- Look at the photograph. Hairstyles, eye makeup and eye color can be altered, so focus your attention on the person's nose and chin. These features don't change. When encountering people with beards or facial hair, cover the facial hair portion of the photo and concentrate on the nose or ears.
- Look at the height and weight. They must reasonably match the person.
- Look at the date of birth and do the math! Pre-printed age charts can be helpful.
- Compare the age of the I.D. with the person's apparent age. For example, if the I.D. says the person is 22, but they only look 17, do not accept the I.D. no matter how genuine it looks.
- Look at the expiration date. If the I.D. has expired, it is not acceptable.

A = ASK

- Ask questions of the person, such as their middle name, zodiac sign, or year of high school graduation. Ask them the month they were born. If they respond with a number, it is probably because they are lying. If the person is with a companion, ask the companion to quickly tell you the person's name. Any hesitation means they are probably lying.
- Ask the person to sign their name, and then compare signatures.

G = GIVE BACK

- If the I.D. looks genuine, give the I.D. back to the customer and make the sale. If the I.D. is phony or altered, you should still return the I.D. Only peace officers are authorized to seize false I.D. documents. Also, there could be legal repercussions if you take another person's property. Licensees should consult with their attorneys before having a policy of confiscating false I.D.'s from customers.



INTOXICATION

What is the Legal Limit?

In most states .08% Blood Alcohol Content (B.A.C.) is the legal limit. A few states have begun to lower that limit down to 05%!!

FACTS

- * One 12 oz beer = 1 drink
- * One 4 oz glass of wine = 1 drink
- * Our drink sizes:
 - Beer - small 14 oz.
 - Beer - large 24 oz. (20 oz. in a few states)
 - Wine - 6 oz.

If a 150 lb person has 2 beers in 2 hours, they will be at .05% B.A.C. (Our large beer = 2 beers).

It takes about 1 hour to eliminate the alcohol in a standard serving.

Refer to the Drink Chart Guide on the following page to determine how much an average person can drink.

First Stage

- * Alcohol reduces inhibitions (visible warning signs)
 - * Overly friendly
 - * Speaking too loudly
 - * Annoying others around them and/or cast members

Second Stage

- * Alcohol impairs judgment
 - * Uses foul language
 - * Makes irrational statements
 - * Becomes belligerent and argumentative

YOU NEED TO STOP SERVING IF IT HAS REACHED THIS POINT!! GET THEM A SAFE RIDE HOME!!

Third Stage

- * Alcohol slows down reactions
 - * Lack of eye focus
 - * Slurred speech
 - * Glassy-eyed

Fourth Stage

- * Alcohol hinders coordination
 - * Spilling/dropping things
 - * Stumbling
 - * Falling





DRINK CHART GUIDE

YOUR WEIGHT	NUMBER OF DRINKS*							
90 to 109	1	2	3	4	5	6	7	8
110 to 129	1	2	3	4	5	6	7	8
130 to 149	1	2	3	4	5	6	7	8
150 to 169	1	2	3	4	5	6	7	8
170 to 189	1	2	3	4	5	6	7	8
190 to 209	1	2	3	4	5	6	7	8
210 to 229	1	2	3	4	5	6	7	8
230 & UP	1	2	3	4	5	6	7	8

 (.01% - .04%) May be DUI.

 (.05% - .07%) Likely DUI.

 (.08% - UP) Definitely DUI

 (.10% - UP) in some states for DUI

* – Over a two hour period: 1 1/4 oz. 80 proof liquor,
12 oz. can of beer or
4 oz. of wine



HANDLING PROBLEMS

First and foremost, effective training of your cashiers and birthday hosts/showroom attendants can help to recognize and prevent these types of situations. Occasionally, however, a situation may arise - you and your cast members need to know what to do. All stores should already have and shown to all Cast Members the Security Video - "How to Handle Emergency Situations". It explains how to handle these types of cases. Here are some additional tips:

Cutting off service to a guest can be done with few problems when the proper intervention techniques are used.

What is intervention? Intervention is the cutting off of alcohol service to guests.

Who decides to intervene? The watchful server or cashier should be the first to notice that a guest has become intoxicated. Because the decision that a guest is intoxicated is a judgment call, get a second opinion.

Who intervenes? The manager needs to handle alcohol intervention cases. While a cashier can tell a guest that they can no longer be served, the manager should handle the situation.

For example: A guest comes up to the cashier and wants another beer. She has seen him have 2 already and he appears a little too "friendly". The cashier should then say, "Excuse me, sir. I've got to get change. I'll be back in a minute." Get the manager to handle the situation!

Wait until the guest asks for a drink before refusing service. There is no use telling a guest of your decision to stop service unless the guest asks for another drink. Do not risk angering the guest by saying "This is the last drink for you tonight." Do not cut a guest off while he/she has a drink and is contented. Wait until the guest asks for the next one.

Be friendly. Introduce yourself if you have not done so previously. "Good evening, sir. My name is Tom. Are you enjoying yourself this evening?" Do not approach a guest in a threatening or disapproving manner. Being friendly is the best practice.

Do not be judgmental. Do not blame the guest for drinking too much. Do not say, "You're drunk." Your guest may have miscalculated and accidentally had one too many. Give your guest the benefit of the doubt. The guest will probably regret having had too much alcohol when his/her judgment is less impaired.

Do not embarrass your guest. Avoid a public scene. Quietly tell the guest that you can no longer serve him/her alcohol. In some cases, it may be better to ask a guest to speak to you near the entrance.



Ask for help when necessary. If one guest at a table has been drinking more heavily than his/her friends, ask a responsible person in the group to help you in offering the intoxicated guest something other than alcohol to drink. Use peer pressure whenever it might help.

Alert a backup. When you discontinue service, tell the cashiers. Do not approach an intoxicated guest with the bad news of "no more alcohol" without having someone monitor the situation. The backup should be standing by, not approaching the guest with you. Two or more persons confronting the guest can be threatening.

Shift the blame. The guest is less likely to get angry if the one to blame for his/her being cut off is not you, but the liquor code, or even the police.

"I'm sorry, but my manager won't let me serve you another drink. It's the house policy. How about some coffee or iced tea?"

Offer alternatives to alcohol. Cutting off service of alcohol is easier if you have alternatives to offer. Know what the alternatives are and whether they will be offered free or at a charge.

Coffee does not help sober a guest, but does buy time for some of the alcohol to be burned up. Hot beverages take more time to drink than cold ones.

Food, especially high protein or fatty food (ie pizza), is good to offer since it slows the absorption of alcohol in the guest's stomach and, again, buys time.

"I'm sorry, I can't serve you any more alcohol at this time. May I bring you a cup of coffee and some breadsticks?"

Express your concern for the guest's well being. Resisting you is more difficult for the guest when you show concern for his/her welfare. The guest feels understood when you sympathize with him/her.

"I'm sorry, but I can't serve you any more alcohol. We're concerned about you and want to make sure you get home safely and come visit us again."

Be firm. Once you have told a guest you are cutting off service, do not change your mind. Do not allow the guest to bargain for "just one more." Stand by your decision. Be careful not to let other guests at the table ruin your efforts by passing drinks to the guest who has been cut off.

Remember that it is illegal to serve intoxicated individuals, whether they are driving or not.

Do not be misled by a red-level guest who says he/she is not driving so it is okay to continue service. It's not. It is against the law.



Repeat yourself as often as necessary. Your guest is not at their rational best. Do not argue. Do not go into detail. Just repeat the statements as many times as necessary. Your guest's reactions may be slowed. It may take him/her a while to really get the message.

Remain calm. Losing your temper or becoming irritated will not benefit you. It only makes matters worse. Practice what you need to say, so you will be comfortable when you have to say it. If your guest becomes hostile or says offensive things to you, try to ignore it. Remember, he/she is intoxicated. Do not take the comments personally, and never lower yourself by making offensive comments in return. Of course, if the guest's offensiveness continues beyond a remark or two, state that the guest will be asked to leave.

Do not use physical force. Do not touch a guest. If a guest becomes physically pushy, try to avoid him/her. If necessary, ask your backup to call the police.

GUEST SAFETY

Do not let an intoxicated guest drive. Use every persuasive means possible to prevent the intoxicated person from driving.

For the safety of your guest, the safety of other people on the road, and for your own legal protection, do not let an intoxicated patron drive away. Even if you turn a guest away at the door because he was intoxicated before he/she arrived, do not let him/her drive away. The threat to other lives and to your job is too great. Remember, too, that alcohol may not show its effect for up to 30-90 minutes after a person has consumed it.

Preventing an intoxicated guest from driving. Know our company policy about alternate transportation. Know who will be responsible for dealing with a guest in this situation. **At our expense suggest that you will call a cab or a family member to pick him/her up.**

If a guest insists on driving, tell him/her "the police are really cracking down around here," or "the police are watching us carefully and checking patrons who drive away." The guest might think he/she will get a citation should he/she choose to drive. Should you meet a guest who cannot be prevented from driving through persuasive means, **do not use physical force.** Politely tell the **guest that you will call the police if he/she drives away.** Make sure the guest understands that law enforcement will definitely be called. If he/she drives, get the car's license number and call. You could be held liable if the guest causes injury to an innocent party, and you have not contacted law officers to warn them of the intoxicated driver. Always document this situation on an incident report.



HELPFUL HINTS

- 1) A guest at the cash register wants to buy more than 1 drink?
Remember, One I.D. per drink!
- 2) A birthday hostess doing a party is asked to serve alcohol. Can she bring them their drinks?
No! Direct the guest to the Order Counter
- 3) Showroom attendants need to count beer cups as they pre-bus tables to help us monitor alcohol consumption by our guests.
- 4) When in doubt (I.D.'s, how much someone's had to drink) **GET THE MANAGER!!**
- 5) **IF YOU ARE NOT OF LEGAL AGE - You cannot participate in the service of alcohol in any manner!!!**





RESPONSIBLE ALCOHOL SERVICE TRAINING ACKNOWLEDGMENT

I have participated in the Responsible Alcohol Service Training Program for CEC Entertainment, Inc. dba Chuck E. Cheese's. During the program, I received information concerning the Company's policy on alcohol service and procedures for serving and monitoring the consumption of alcohol by our guests. I was also given information regarding the potential civil and criminal liabilities myself; the servers and the Company could face if I don't follow the prescribed procedures. I understand that if I violate the Company's policy regarding the responsible service of alcohol, I may be subject to disciplinary action up to and including termination.

Signature of Participant:

Print Name:

Date of Training: _____

Location: _____

Training Conducted by:



STATE OF ALASKA
ALCOHOL BEVERAGE CONTROL BOARD
Licensed Premises Diagram

INSTRUCTIONS: Draw a detailed floor plan of your present or proposed licensed premises on the graph below; show all entrances and exits, and all fixtures such as tables, booths, games, counters, bars, coolers, stages, etc.

DBA: CHUCK E. CHEESE'S

PREMISES LOCATION: 308 E. Northern Lights Boulevard, Anchorage, AK

Indicate scale by x after appropriate statement or show length and width of premises. x 1 SQ. = ~~4~~ FT. approx 4.16

SCALE A: 1 SQ. = 1 FT. **SCALE B:**

Length and width of premises in feet: Dimensions: Irregular shape; approx 11,680 sf
Liquor is purchased at Order Counter only, but
can be consumed at any of the tables and booth areas.
Outline the area to be designated for sale, service, storage, and consumption of alcoholic beverages in red.
DO NOT USE BLUE INK OR PENCIL ON THIS DIAGRAM.

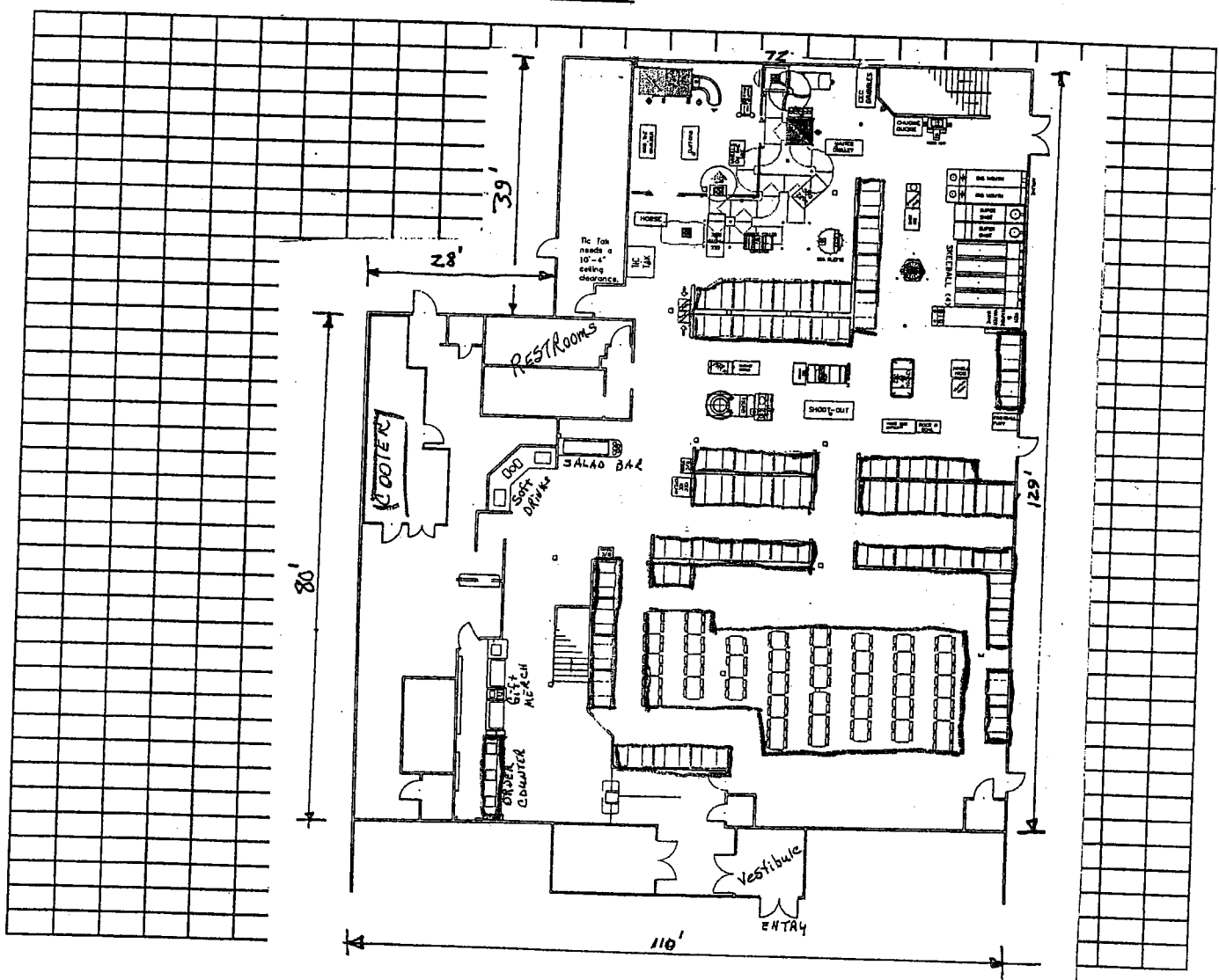

JAN 2005 FLOOR PLAN - PRIOR TO REMODEL

Rev
4-29-06 051

CHUCK E. CHEESE'S Exterior Elevations



ARCHITECTURE PLANNING - DESIGN
LARRY W. HARRIS, AIA
100 W. ELSTON AVE., SUITE 100
CHICAGO, IL 60640
PH: 312.467.1100

ANCHORAGE, AK

CHUCK E. CHEESE'S PIZZA #589

EXTERIOR ELEVATIONS

C. E. CHEESE'S, INC.
1401 WEST 10TH AVENUE
ANCHORAGE, AK 99503

DATE: 11/28/2005

SCALE: AS SHOWN

A4.0

FINISH KEY

SPROCK GRANITONS

1. FINISH WITH GRANITONS. GRANITONS ARE AVAILABLE IN MANY COLORS AND FINISHES. GRANITONS ARE AVAILABLE IN 1/2" AND 1" SQUARES. GRANITONS ARE AVAILABLE IN 1/4" AND 1/2" CIRCLES. GRANITONS ARE AVAILABLE IN 1/4" AND 1/2" DIAMETERS. GRANITONS ARE AVAILABLE IN 1/4" AND 1/2" SQUARES. GRANITONS ARE AVAILABLE IN 1/4" AND 1/2" CIRCLES. GRANITONS ARE AVAILABLE IN 1/4" AND 1/2" DIAMETERS.

2. GRANITONS ARE AVAILABLE IN MANY COLORS AND FINISHES. GRANITONS ARE AVAILABLE IN 1/2" AND 1" SQUARES. GRANITONS ARE AVAILABLE IN 1/4" AND 1/2" CIRCLES. GRANITONS ARE AVAILABLE IN 1/4" AND 1/2" DIAMETERS. GRANITONS ARE AVAILABLE IN 1/4" AND 1/2" SQUARES. GRANITONS ARE AVAILABLE IN 1/4" AND 1/2" CIRCLES. GRANITONS ARE AVAILABLE IN 1/4" AND 1/2" DIAMETERS.

FINISH LEGEND

FINISH P-1 SAND

FINISH P-11

FINISH P-12

FINISH P-13

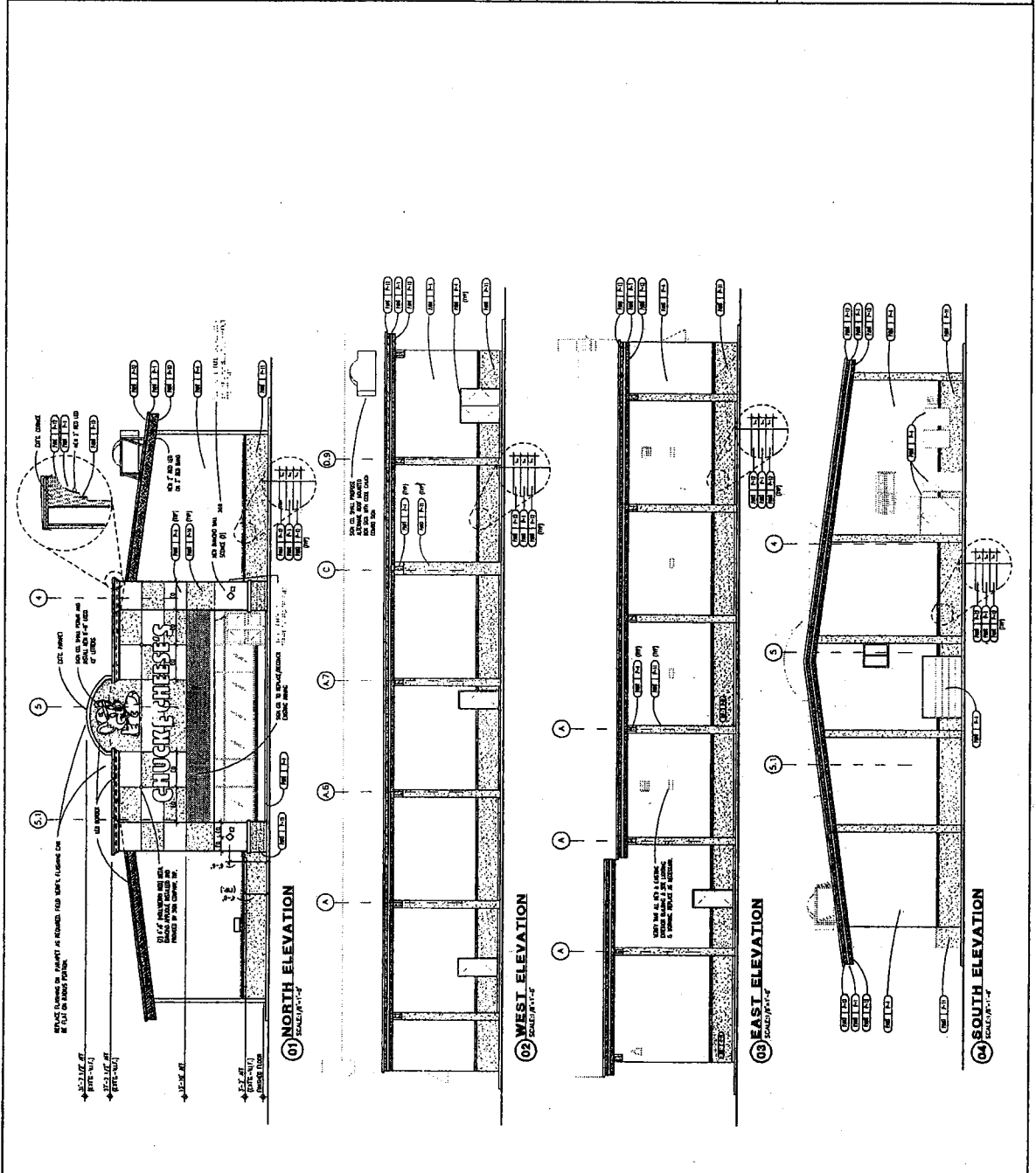

msn Maps & Directions

Featuring Microsoft® MapPoint® Technology

308 E Northern Lights Blvd, Anchorage, AK 99503

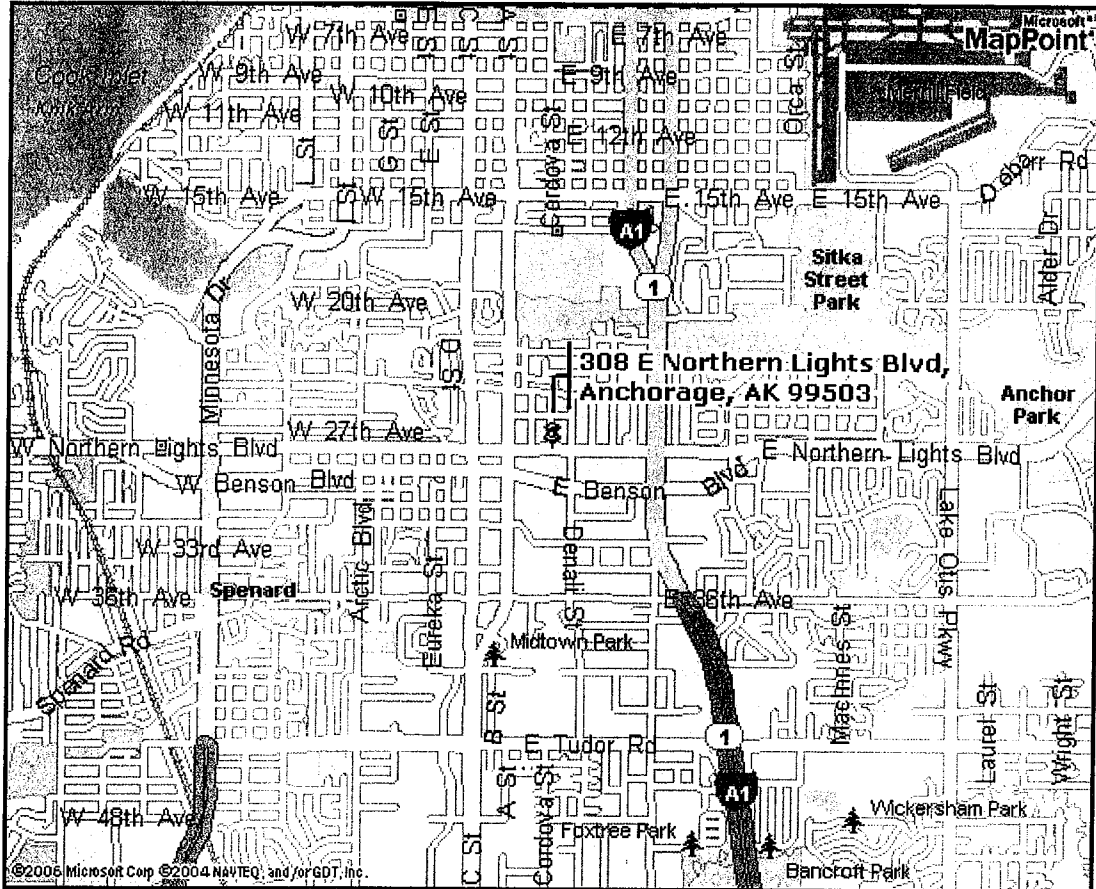

Your right to use maps and routes generated on the MSN service is subject at all times to the MSN Terms of Use. Data credits, copyright, and disclaimer.

PLAN INFORMATION		04/18/2006
LOCATION:	CHUCK E. CHEESE'S #589 308 EAST NORTHERN LIGHTS ANCHORAGE, AK 99503	
BEFORE REFERENCE: A1.1	1ST FLOOR AREA: 11,218 S.F. (NET) 2ND FLOOR AREA: NO PUBLIC OCCUPANCY TOTAL BLDG. AREA: 11,281 S.F. (NET) SEATING CAPACITY: 392 SEATS	
AFTER REFERENCE: A1.2 & A1.3	1ST FLOOR AREA: 11,057 S.F. (GROSS) 2ND FLOOR AREA: 7,231 S.F. (GROSS) TOTAL BLDG. AREA: 18,288 S.F. (GROSS) SEATING CAPACITY: 447 SEATS	
NOTE: REFERENCE APPROPRIATE PLAN FOR ADDITIONAL INFORMATION ON SEATING LAYOUT AND TABLE COUNT.	SEATING INCREASE: 55 SEATS	

NOTE: "BEFORE" DI AN IS BASED

DOCUMENTS FOR ANY PURPOSE OTHER THAN CONSTRUCTION OF THIS PROJECT WITHOUT EXPRESSED WRITTEN PERMISSION OF THE ARCHITECT AND CEG ENTERTAINMENT, INC.

JAMES M. HAMILT
1010 W. EULESS BLVD.
EULESS, TX 76040

ARCHITECTURE - PLANN

ANCHORAGE, AK

UCK E. CHEESE'S PIZZA.
EAST NORTHERN LIGHTS
ANCHORAGE, AK 99503

#589

OR PLAN, 2002 - "BEFORE"

C. ENTERTAINMENT, INC.
WEST AIRPORT FREEWAY
ANCHORAGE, AK 99503

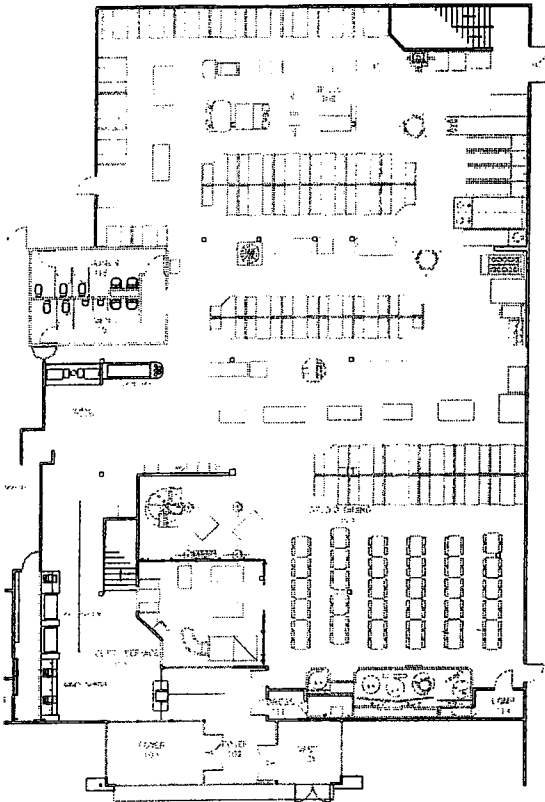

PLAN INFORMATION		04/18/2006
LOCATION:	DICKI & CHEESE'S PIZZA 308 EAST NINTH STREET ANCHORAGE, AK 99501	
"BEFORE" REFERENCE: #1	1ST FLOOR AREA: 11,276 S.F. (NET) 2ND FLOOR AREA: 40 PUBLIC OCCUPANCY TOTAL BLDG. AREA: 11,276 S.F. (NET) SEATING CAPACITY: 300 SEATS	
"AFTER" REFERENCE: #1, 2 & #1.1	1ST FLOOR AREA: 11,007 S.F. (GROSS) 2ND FLOOR AREA: 1,231 S.F. (GROSS) TOTAL BLDG. AREA: 12,238 S.F. (GROSS) SEATING CAPACITY: 447 SEATS	
NOTE: REFERENCE APPROXIMATE PLAN FOR SEATING INFORMATION ON SEATING LAYOUT AND TABLE COUNT.	SEATING PACKAGE: 55 SEATS	

NOTE: "BEFORE" PLAN IS BASED ON INFORMATION PROVIDED BY OTHERS. FIELD VERIFY CRITICAL DIMENSIONS.

NOTE: SECOND FLOOR IS NOT OPEN FOR PUBLIC OCCUPANCY.

SEATING	
CANES DINING (BOOZE)	56
CANES DINING (SHALLS)	185
STOOD DINING	177
TOTAL SEATS	322
TOTAL AREA (FIRST FLOOR):	11,281 SQ.FT.



ANCHORAGE, AK

PROJECT NUMBER: #589
 CHUCK E. CHEESE'S PIZZA
 308 EAST NINTH STREET
 ANCHORAGE, AK 99501
 C. E. C. ENTERTAINMENT, INC.
 1000 W. 10TH STREET
 ANCHORAGE, AK 99501
 FLOOR PLAN, 2002 - "BEFORE"

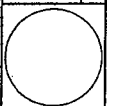

Date: 04/18/2006
 Revision:

Project Number: 11-426-2006
 Sheet Number: A11
 of 3

州 長 官 印 記 欄



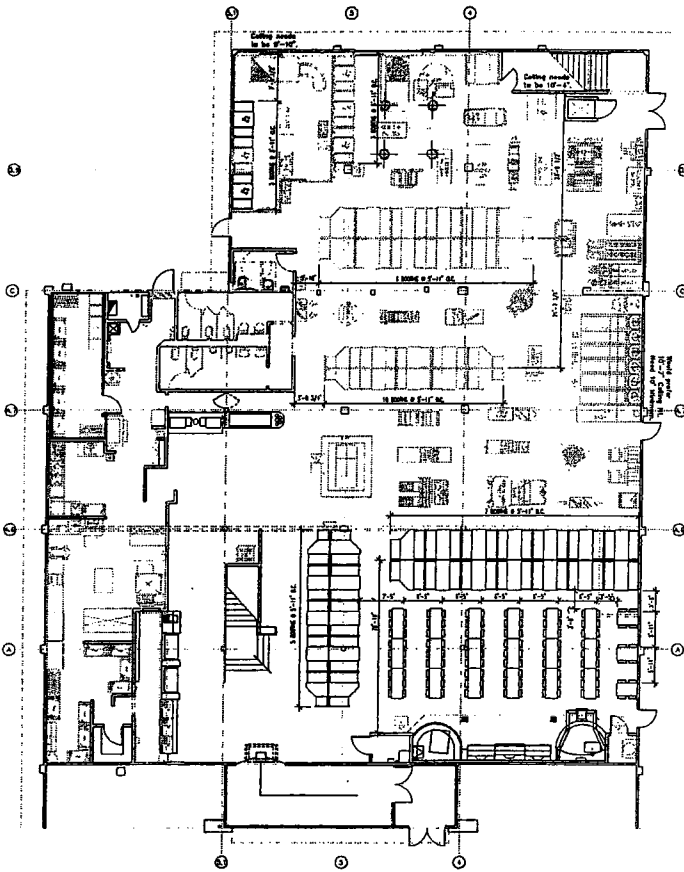

01 FURNISHINGS PLAN - GROUND FLOOR
SCALE: 1/8" = 1'-0"

SEATING

SEATING	SEATING	SEATING
1st Floor	1st Floor	1st Floor
2nd Floor	2nd Floor	2nd Floor
3rd Floor	3rd Floor	3rd Floor
4th Floor	4th Floor	4th Floor
5th Floor	5th Floor	5th Floor
6th Floor	6th Floor	6th Floor
7th Floor	7th Floor	7th Floor
8th Floor	8th Floor	8th Floor
9th Floor	9th Floor	9th Floor
10th Floor	10th Floor	10th Floor

PLAN INFORMATION 04/18/2006

LOCATION:	CHUCK E. CHEESE'S B&B 308 EAST ANDREWS LANE ANCHORAGE, AK 99501
"BEFORE" NOTES: A1.1	1ST FLOOR AREA: 11,218 S.F. (NET) 2ND FLOOR AREA: 10,234 S.F. (NET) TOTAL BLDG. AREA: 21,452 S.F. (NET) SEATING CAPACITY: 382 SEATS
"AFTER" NOTES: A1.2 & A1.3	1ST FLOOR AREA: 11,857 S.F. (GROSS) 2ND FLOOR AREA: 12,231 S.F. (GROSS) TOTAL BLDG. AREA: 24,088 S.F. (GROSS) SEATING CAPACITY: 417 SEATS
ARE. REFERENCE APPROPRIATE PLAN FOR ADDITIONAL INFORMATION ON SEATING LAYOUT AND TABLE COUNT	SEATING INCREASE: 35 SEATS



#589
ANCHORAGE, AK
GROUND FLOOR PLAN, 2006 - AFTER

CHUCK E. CHEESE'S PIZZA
308 EAST ANDREWS LANE
ANCHORAGE, AK 99501
DATE: 04/18/2006
PROJECT NUMBER: 03-089-2005
SHEET NUMBER: **A1.2**

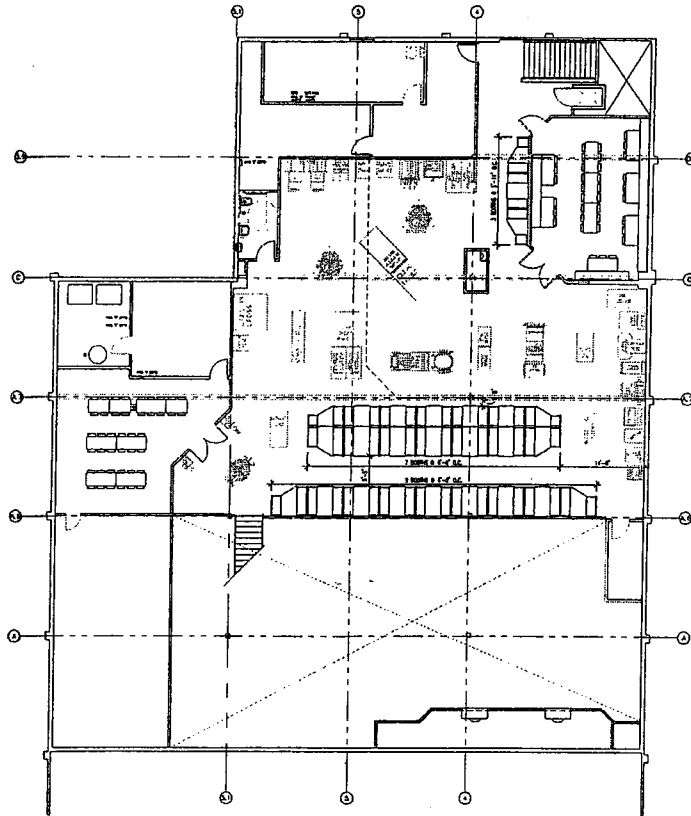

01 FURNISHINGS PLAN - SECOND FLOOR
SCALE: 1/8" = 1'-0"

SEATING	
LOCATION: 1st Floor	DATE: 07/17/2006
Location	103
1ST FLOOR AREA	103
2ND FLOOR AREA	178
LOCATION: 2nd Floor	
Location	103
1st Floor Area	103
2nd Floor Area	178
SEATING CAPACITY	103
1ST FLOOR SEATING	103
2ND FLOOR SEATING	103

PLAN INFORMATION		01/18/2006
LOCATION:	CHUCK E. CHEESE'S (508 3RD EAST NORTHERN LIGHTS ANCHORAGE, AK 99501)	
"BEFORE" REFERENCE: ALL	1ST FLOOR AREA: 11,310 S.F. (NET) 2ND FLOOR AREA: 80 PUBLIC OCCUPANCY TOTAL BLDG. AREA: 11,390 S.F. (NET) SEATING CAPACITY: 307 SEATS	
"AFTER" REFERENCE: A1.3 & A1.3	1ST FLOOR AREA: 11,007 S.F. (GROSS) 2ND FLOOR AREA: 2,321 S.F. (GROSS) TOTAL BLDG. AREA: 13,328 S.F. (GROSS) SEATING CAPACITY: 417 SEATS	
NOTE: REFERENCE APPROPRIATE PLAN FOR ADDITIONAL INFORMATION ON SEATING LAYOUT AND TABLE COUNT.	SEATING INCREASE: 11 SEATS	

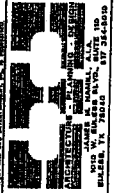

CHUCK E. CHEESE'S PIZZA
508 3RD EAST NORTHERN LIGHTS
ANCHORAGE, AK 99501

#589
ANCHORAGE, AK
C. E. CHEESE
1000 W. 10TH AVENUE, SUITE 100
ANCHORAGE, AK 99501
SECOND FLOOR PLAN 2006 - "AFTER"

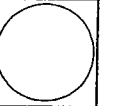

Date: 04/18/2006
Architect:
Project Number: 00-000-0000

Sheet Number: **A1.3**
of 3

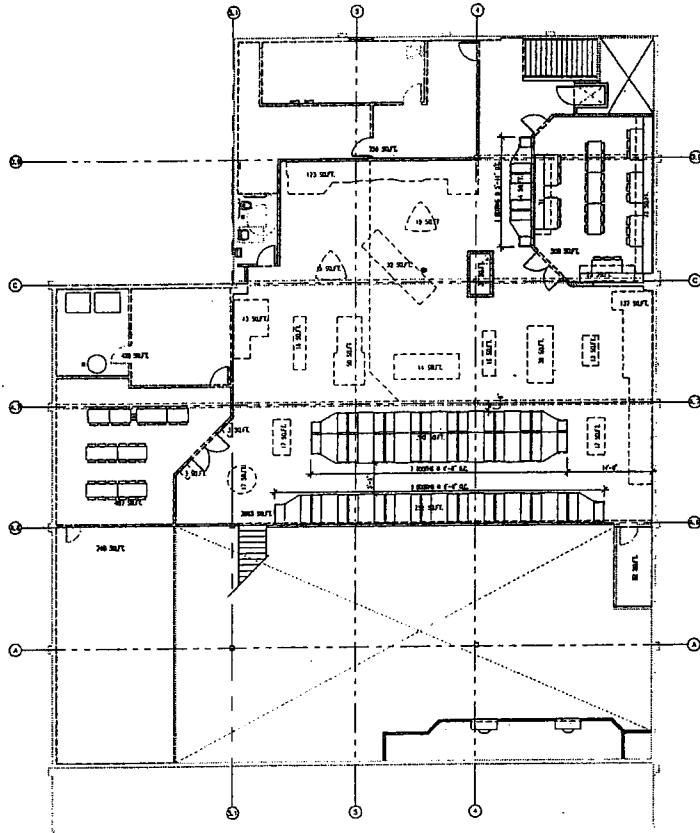

01 OCCUPANCY PLAN - SECOND FLOOR
SCALE: 1/8" = 1'-0"

SEATING	
SECTOR	TABLE
SECTOR: 2nd Floor	
Personnel	16
Guests	28
2ND FLOOR TOTAL SEATING	44
SECTOR: 3rd Floor	
Personnel	16
Guests	28
3RD FLOOR TOTAL SEATING	44
TOTAL BUILDING SEATING	88

SECOND FLOOR AREA:

- A) CROSS AREA: 1,063 SQ. FT.
- B) AREA COVERED BY GAMES: 522 SQ. FT.
- C) AREA COVERED BY BOOTHS: 592 SQ. FT.
- D) TOTAL AREA COVERED BY GAMES AND BOOTHS: 1,114 SQ. FT.
- E) NET AREA FOR OCCUPANCY: 2849 SQ. FT.
- F) OCCUPANT LOAD FACTOR: 15 SQ. FT. / PERSON
- G) OCCUPANCY: 176 PEOPLE
- H) THEAT SEATING COURSE: 80 PEOPLE
- I) TOTAL OCCUPANCY KNOCK AREA: 256 PEOPLE

PRIVATE PARTY ROOMS AREA:

OCCUPANCY BASED ON SEATING ONLY: 96 PEOPLE

SECOND FLOOR TOTAL:

SECOND FLOOR TOTAL OCCUPANCY: 352 PEOPLE



CHUCK E. CHEESE'S PIZZA
ANCHORAGE, AK
1000 W. WARD BLVD. ANCHORAGE, AK 99501
PHONE: 481-1111 FAX: 481-1112

ANCHORAGE, AK
#589

CHUCK E. CHEESE'S PIZZA
400 EAST ANCHORAGE LIGHTS
ANCHORAGE, AK 99501
C.E.C. ENTERTAINMENT, INC.
1000 W. WARD BLVD. ANCHORAGE, AK 99501
PHONE: 481-1111 FAX: 481-1112

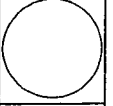

Date: 04/24/2008

Project Number: 18-998-2005

Sheet Number: OCC2
of 1 OF 2

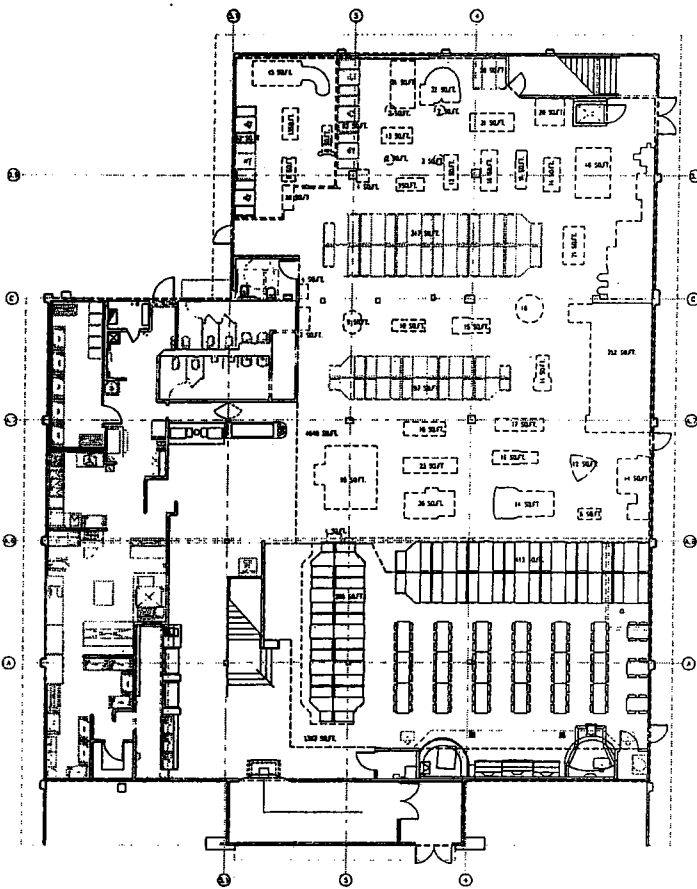

01 OCCUPANCY PLAN - GROUND FLOOR
SCALE: 1/8" = 1'-0"

SEATING	
Location, Size, Type	Count (by / total)
Bar	142
Bar Booth	8
Bar Booth Wall Seating	70
SECOND FLOOR	
Bar	88
Bar Booth #1	54
Bar Booth #2	42
Bar Booth Wall Seating	130
Bar Booth Wall Seating	142

CHUCK E. CHEESE'S #589
ANCHORAGE, AK.

BUILDING CODE: ANCHORAGE CITY BUILDING CODE, I.B.C., 1990
 CONSTRUCTION TYPE: IV, SPRINKLERED
 BUILDING AREA: 18,288 SQ. FT. (GROSS)
 FORESS WIDTH: 230'
 GROSS CAPACITY (TABLE 1003.2.2, p. 215): 1,506 PEOPLE
 MIN. PLUMBING FACILITIES (TABLE 2902.1, p. 611)
 LAV: 1/200, 8 LAVS. TOTAL: 1,200
 W.C.: 1/75, 8 W.C. TOTAL: 875

GAMES AREA, GROUND FLOOR:

- A) GROSS AREA: 4,884 SQ. FT.
- B) AREA COVERED BY GAMES: 1,800 SQ. FT.
- C) AREA COVERED BY BOOTHS: 883 SQ. FT.
- D) TOTAL AREA COVERED BY GAMES AND BOOTHS: 2,683 SQ. FT.
- E) NET AREA FOR OCCUPANCY: 2,683 SQ. FT.
- F) OCCUPANT LOAD FACTOR: 15 SQ. FT. / PERSON
- G) OCCUPANCY: 179 PEOPLE
- H) FOOD SEATING COUNT: 88 PEOPLE
- I) TOTAL OCCUPANCY GAMES AREA: 267 PEOPLE

STUDIO "C", GROUND FLOOR AREA:

OCCUPANCY BASED ON SEATING ONLY: 183 PEOPLE

SECOND FLOOR TOTAL:

SECOND FLOOR TOTAL OCCUPANCY: 332 PEOPLE

OCCUPANCY CALCULATIONS:

- A) GAMES: 4,884 - 1,000 = 3,884 / 15 = 197 + 88 = 285 PEOPLE
- B) STUDIO "C" (BASED ON SEATING) = 183 PEOPLE
- C) SECOND FLOOR = 332 PEOPLE
- TOTAL BUSINESS PUBLIC OCCUPANCY = 871 PEOPLE



CHUCK E. CHEESE'S PIZZA #589
 ANCHORAGE, AK
 C. E. C. ENTERTAINMENT, INC.
 ANCHORAGE, ALASKA
 ANCHORAGE, AK
 AREA - GROUND FLOOR

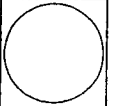

Date: 08/24/2006
 Project Number: 88-589-2006

Sheet Number: **OCC1**
 of 1 of 2

HISTORICAL INFORMATION

LIQUOR LICENSE BROWSE

LICENSE INFORMATION

List	License Number 1744	Action Type Transfer	Action Date 05/17/2005
1652	Approval Date 05/17/2005	Protest Date 05/17/2005	License Document AM 637-2005
1660	Restaurant Date	License Status Valid/Active	Status Date 04/08/2003
1666	Soc. Sec. Num.	Fed. EIN Num. 48-0905805	ABC App. Date 05/18/2005
1679	License Type Restaurant/Eating Place	License Years 05-06	
1682	Comment AM 639-2005 app 5/17/05 former owners were C&A restaurants AM 281-2003 app 4/8/03 AM 229-2001 app January 29, 2001		
1691	Tax ID 009-041-06-000	Tax ID Verified No	
1696			
1697			
1701			
1709			
1721			
1732			

BUSINESS INFORMATION

Name	Chuck E. Cheeses
Address	308 E Northern Lights Anchorage, AK 99503
Phone 1	(907) 274-9528
Phone 2	(972) 253-5523
Community Councils	Midtown North Star

APPLICANT INFORMATION

Name	GEO Entertainment Inc
Address	441 W Airport Freeway Irving, TX 75032

CONDITION DOCUMENTS

Document Num.	Condition Type	Request Date	Approval Date
AM 145-82	Land Use Conditions		
Comment			

OWNER INFORMATION

Owner Name	Address	City	State	Zip
Frank Richard M. GEO	4923 Deloache Ave	Dallas	TX	75220
Maguslak, Micheal H. Pres	5300 Burgundy Ct	Colleyville	TX	76034



MUNICIPALITY OF ANCHORAGE

ASSEMBLY MEMORANDUM

APPROVED

No. AM 145-82

Date 2-7-82
30 Allegan Williams

Meeting Date: February 9, 1982

From: Municipal Clerk

Subject: New Restaurant Liquor License: Chuck E. Cheese Pizza Time Theater

The Municipality of Anchorage has received notice from the Alcoholic Beverage Control Board of an application for a new restaurant liquor license as follows:

Northern Pizza Restaurants Inc.
Larry Caudle
308 E. Northern Lights
Anchorage, AK 99503
DBA: Chuck E. Cheese Pizza Time Theater
308 E. Northern Lights
Anchorage, AK 99503

The premises to be licensed is located within an area zoned B-3. There is an estimated population of 187-761 within the Municipality of Anchorage, and there are 97 existing licenses within the same classification as requested by the applicant. Notice of the application was mailed to 49 property owners within 500 feet of the proposed licensed premises on January 26, 1982, and a newspaper advertisement was published on January 24, 1982, advising the public of the application.

Staff review of the application indicates:

FIRE: Disapproved--reconstruction not approved for an occupancy certificate by building & fire departments.
TAXES: None owing
POLICE: No objection
UTILITIES: None owing

AMC 21.45.170 requires that any use, whether principal or accessory, involving the retail, sale or dispensing of alcoholic beverages is permitted only by special exception. The special exception requirement under that section applies only to the retail sale and dispensing of alcoholic beverages and not to related principal or accessory uses. Moreover, AS 04.11.480 provides that if the Assembly wishes to protest the issue of a new liquor license, it may protest within 30 days following receipt of notice of the application and that the protest will be honored unless the board finds the protest is arbitrary, capricious and unreasonable.

Based on the staff review described above, it is recommended that, pursuant to AMC 21.45.170 the special exception for the use involving alcoholic beverages be approved subject to complying with all building and fire code regulations. Approval of this memorandum will grant the special exception under AMC 21.45.170 subject to the above and will waive the Assembly protest under AS 04.11.480.

Respectfully submitted,

Ruby E. Smith
Ruby E. Smith
Municipal Clerk

NOTE: Chuck E. Cheese Pizza Time Theatre is also under New Business as Restaurant Designation.

POLICE DEPARTMENT CHECK LIST FOR INVESTIGATION OF LIQUOR LICENSE APPLICATIONS

1. Criminal record in local police files? no
2. Violations occurring within licensing year:

<u>Type of Incident</u>	<u>Arrest</u>		<u>Did Establishment Notify</u>	
	<u>Yes</u>	<u>No</u>	<u>Yes</u>	<u>No</u>
-0-		-0-		-0-

Chuck E. Cheese Pizza Time Theatre
Business Name

308 E. Northern Lights, Anchorage
Location

Larry L. Caudle, Ellen Caudle, Lauren Ward, Richard Taylor
Name of Applicant

- New
- Renewal
- Transfer of License
- Transfer of Location
- Quarterly Review

RECOMMENDATION: Approved (X)
Disapproved ()

January 15, 1982
Date

Primo S. Foster
Chief of Police

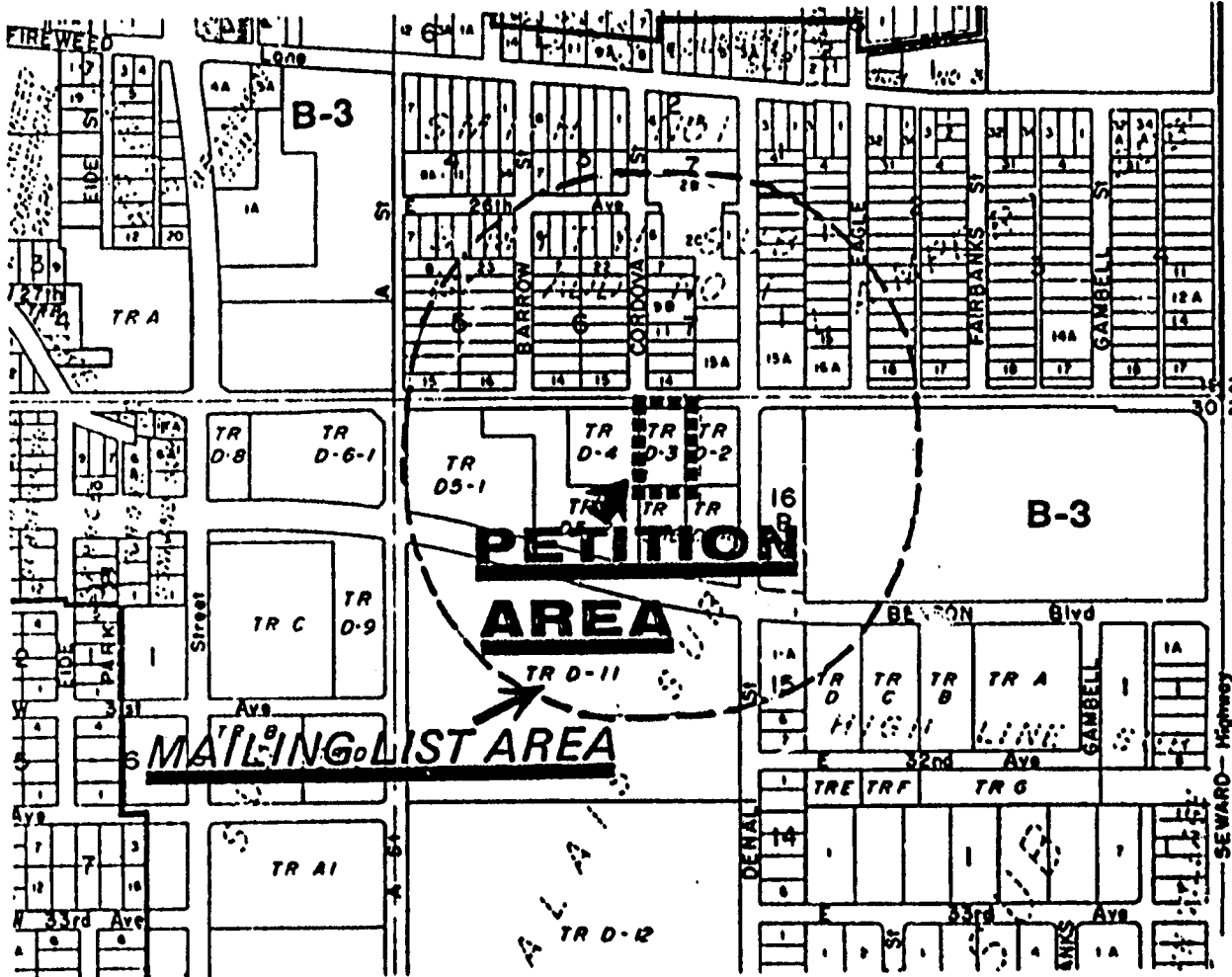

RESTAURANT BEER AND WINE, PIZZA TIME THEATER
 308 E. NORTHERN LIGHTS BLVD, TRACT D-3, CALAIS SUBDIVISION
 ZONING: B-3
 LIKE LICENSES WITHIN THE MUNICIPALITY: 97
 CURRENT POPULATION ESTIMATE WITHIN THE MUNICIPALITY: 187,761



Municipality Of Anchorage

Building Safety Division



ZONING COMMENTS

Reviewed by: **AGLER, DEB A.**

Permit #: **05- -6389**

Phone: 343-8397

Date: 3/23/2006

Fax: 249-7453

Lot: Block: Tract: Subdivision: CALAIS

Project: CHUCK E CHEESE



Contact:	Name:	Phone:	Fax:
OWNER	CALAIS CO INC		
ARCHITECT/DESIGNER	JAMES M HAMILL	(817) 354-6010	(817) 571-1919
CONTACT PERSON	DANIEL CANTU	(817) 354-6010	(817) 571-1919
GENERAL CONTRACTOR	TBA	() - /	() -
PERMITEE	DANIEL CANTU	(817) 354-6010	(817) 571-1919

Plan Review Comments:

1. Please provide parking calcs. Alterations include additional seating area upstairs. Please show seating chart as well as a site plan depicting all existing and proposed parking. AMC 21.45.080 Please note that additional landscaping may be required depending on the number of additional parking spaces. AMC 21.45.125 Zoning review incomplete, pending additional submittals. /da
2. Please contact Community Planning and Development regarding possible amendments to your conditional use involving the sale/dispensing of alcoholic beverages. (enlarging dining area) AMC 21.40.180.D.8 /da
3. Additional discipline reviews may be required pending resolution of above. /da

PARCEL INFORMATION

APPRAISAL INFORMATION		Parcel 009-041-06-000 Owner CALAIS CO INC % CEC ENTERTAINMENT INC ATTN: REAL ESTATE DEPARTMENT PO BOX 150305 ARLINGTON TX 76015 0305	# 
Legal CALAIS TR D3	# Descr NIGHT CLUB/DINNER Site Addr 308 E NORTHERN LIGHTS BLVD		

RELATED CAMA PARCELS		Cross Reference (XRef) Type Legend	Get "Type" explanation																		
Related Parcel(s)	XRef Type	Leased Parcels																			
																					
<table border="0"> <tr> <td>Econ. Link</td> <td>Replat</td> <td>Uncouple</td> </tr> <tr> <td>E = Old to New</td> <td>R = Old to New</td> <td>U = Old to New</td> </tr> <tr> <td>I = New to Old</td> <td>F = New to Old</td> <td>Q = New to Old</td> </tr> <tr> <td>Renumber</td> <td>Combine</td> <td>Lease</td> </tr> <tr> <td>N = New to Old</td> <td>C = New to Old</td> <td>L = GIS to Lease</td> </tr> <tr> <td>X = Old to New</td> <td>P = Old to New</td> <td>M = Lease to GIS</td> </tr> </table>			Econ. Link	Replat	Uncouple	E = Old to New	R = Old to New	U = Old to New	I = New to Old	F = New to Old	Q = New to Old	Renumber	Combine	Lease	N = New to Old	C = New to Old	L = GIS to Lease	X = Old to New	P = Old to New	M = Lease to GIS	Bring up this form focused on the related parcel
Econ. Link	Replat	Uncouple																			
E = Old to New	R = Old to New	U = Old to New																			
I = New to Old	F = New to Old	Q = New to Old																			
Renumber	Combine	Lease																			
N = New to Old	C = New to Old	L = GIS to Lease																			
X = Old to New	P = Old to New	M = Lease to GIS																			

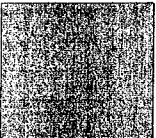

153 reg'd Spruce

REZONE	Case Number 2006-082	# of Parcels 1	Hearing Date 05/03/2006
	Case Type Amending a conditional use for an alcoholic beverage dispensary use		
	Legal An amendment to an alcoholic beverage conditional use for a beverage dispensary license due to remodeling at the Chuck E. Cheese Restaurant. Calais Subdivision, Tract D3. Located at 308 E Northern Lights Blvd.		

PLAT	Case Number	Grid	Proposed Lots 0	Existing Lots
	Action Type		Action Date	
	Legal			

PERMITS	Permit Number 03 5256
	Project
	Work Desc Reroof
	Use OFFICE

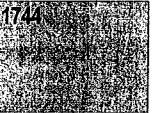
BZAP	Action No.	Status
	Action Date	Type
	Resolution	

ALCOHOL LICENSE	Business Chuck E. Cheese's	Applicants Name CEC Entertainment, Inc.
	Address 308 E. Northern Lights Anchorage, AK 99503	Conditions 
	License Type Restaurant/Eating Place	
	Status Valid/Active	

PARCEL INFORMATION

OWNER
 CALAIS CO INC
 % CEC ENTERTAINMENT INC
 ATTN: REAL ESTATE DEPARTMENT
 PO BOX 150305
 ARLINGTON TX 76015 0305
 Deed 2005 0000171
 CHANGES: Deed Date Jan 03, 2005
 Name Date Jun 02, 2005
 Address Date Jun 13, 2005

PARCEL
 Parcel ID 009-041-06-000
 Status # 01
 Renumbr ID 000-000-00-00000
 Site Addr 308 E NORTHERN LIGHTS BLVD
 Comm Concl MIDTOWN
 Comments PLAT 73-175

TAX INFO
 2006 Tax 21,327.77 Balance 21,327.77 District 003

LEGAL
 CALAIS
 TR D3
 Unit SQFT 37,950
 Plat 760152
 Zone B3 Grid SW1631

HISTORY	Year	Building	Land	Total
Assmt Final	2004	732,000	426,900	1,158,900
Assmt Final	2005	725,000	683,100	1,408,100
Assmt Final	2006	726,500	683,100	1,409,600
Exemptions	SPRINKLER			13,803
State Credit				0
Tax Final				1,395,797

PROPERTY INFO		
#	Type	Land Use
01	COMMERCIAL	NIGHT CLUB/DINNER

SALES DATA				
Mon	Year	Price	Source	Type

LAND & COMMON PARCEL INFORMATION

APPRAISAL INFORMATION

Legal CALAIS
TR D3

Parcel 009-041-06-000 # 01 of 01

Owner CALAIS CO INC
% CEC ENTERTAINMENT INC
ATTN: REAL ESTATE DEPARTMENT
PO BOX 150305
ARLINGTON TX 76015

Site Addr 308 E NORTHERN LIGHTS BLVD

LAND INFORMATION

Land Use NIGHT CLUB/DINNER
Class COMMERCIAL
Living Units 000
Community Council 037 MIDTOWN
Entry: Year/Quality 07 1990 INTERIOR
08 1996 INTERIOR
Access Quality GOOD
Access Type
Leasehold (Y=Leasehold)
Drainage GOOD
Front Traffic HIGH
Street PAVED CURB & GUTTER
Topography HIGH LEVEL
Utilities PUBLIC WATER PUBLIC SEWER
Wellsite N
Wet Land

CONDOMINIUM INFORMATION

Common Area 0
Undivided Interest 0.00

COMMERCIAL INVENTORY

APPRAISAL INFORMATION		Parcel 009-041-06-000	# 01 of 01	01
Legal CALAIS TR D3		Owner CALAIS CO INC % CEC ENTERTAINMENT INC ATTN: REAL ESTATE DEPARTMENT PO BOX 150305 ARLINGTON TX 76015		#
Site Addr 308 E NORTHERN LIGHTS BLVD				
Prop Info # NIGHT CLUB/DINNER				

BUILDING INFORMATION			
Structure Type NIGHT CLUB	Property Information # 01	Building Number 01	
Building SQFT 18,263	Effective Year Built 1976	Identical Units 01	
Year Built 1973		Number of Units 000	
Grade C			

INTERIOR DATA							
Floor	Level	Partitions	Heat System	Air Conditioner	Plumbing	Physical Condition	Functional
01	01	NORMAL	HOT WATER/STEAM	CENTRAL	ADEQUATE	NORMAL	NORMAL
01	01	NORMAL	HOT WATER/STEAM	CENTRAL	ADEQUATE	NORMAL	NORMAL
01	01	NORMAL	HOT WATER/STEAM	CENTRAL	ADEQUATE	NORMAL	NORMAL
02	02	NORMAL	HOT WATER/STEAM	CENTRAL	ADEQUATE	NORMAL	NORMAL
02	02	NORMAL	HOT WATER/STEAM	CENTRAL	ADEQUATE	NORMAL	NORMAL

EXTERIOR DATA								
Floor	Level	Size	Perim	Use Type	Hgt	Wall Type	Const Type	
01	01	4,000	110	CAFETERIA	11	STUCCO ON BLK	FIRE RESISTANT	
01	01	4,000	180	CAFETERIA	21	STUCCO ON BLK	FIRE RESISTANT	
01	01	2,800	75	CAFETERIA	11	CONCRETE TILT-UP	FIRE RESISTANT	
02	02	4,663	296	CAFETERIA	10	STUCCO ON BLK	FIRE RESISTANT	
02	02	2,800	150	CAFETERIA	10	CONCRETE TILT-UP	FIRE RESISTANT	

BUILDING OTHER FEATURES - ATTACHED IMPROVEMENTS				
Type	Qty	Size1	Size2	
CANOPY- SVC STATION	01	2,620		1
ENCLOSED ENTRY	01	351		1
SPRINKLER WET	01	18,263		1

OTHER BUILDINGS AND YARD IMPROVEMENTS					
Type	Size/Amt	Units	Yr/Built	Condition	Funct/Utility
PAVING ASPHALT PK	18,000	01	1973	NORMAL	NORMAL

BUILDING PERMIT INFORMATION

APPRAISAL INFORMATION

Legal CALAIS
TR D3

Parcel 009-041-06-000 # 01 of 01

01

Prop Info # NIGHT CLUB/DINNER
Site Addr 308 E NORTHERN LIGHTS BLVD

Owner CALAIS CO INC
% CEC ENTERTAINMENT INC
ATTN: REAL ESTATE DEPARTMENT
PO BOX 150305
ARLINGTON TX 76015

BUILDING PERMITS

Permit # 03 5312
04 4091
05 6389

Class Type C
Class Use A-2 ASSEMBLY, RESTAURANTS, BAR

Date Dec 28, 2005

Address 308 E NORTHERN LIGHTS BLVD

Cond Occ/Occ 00000000 | 00000000

Certification

Contract Type GENERAL CONTRACTOR

Name TBA

E-mail

Phone () -

Fax () -

Address 4700 S BRAGAW

City/State/Zip ANCHORAGE AK 99504-

Project CHUCK E CHEESE

Sewer / Water PUBLIC | PUBLIC

Work Type ALTERATION

Work T/I

Description

CASES

2006-082

Case Number 2006-082

of Parcels 1

Hearing Date Wednesday, May 03, 2006

PERMIT COMMENT

OWNER HISTORY

APPRAISAL INFORMATION	Parcel 009-041-06-000	# 01 of 01	# 01
Legal CALAIS TR D3			
Property Info # Descr NIGHT CLUB/DINNER	Site Adress 308 E NORTHERN LIGHTS BLVD		

<p>Current 01/03/05</p> <p>CALAIS CO INC % CEC ENTERTAINMENT INC ATTN: REAL ESTATE DEPARTMENT PO BOX 150305 ARLINGTON TX 76015 0305</p>	<p>3rd 0000 0000 //</p>
<p>Prev 3068 0000 05/27/97</p> <p>CALAIS CO INC</p> <p>% FATHERS INC 3601 C STREET #600 ANCHORAGE AK 99503</p>	<p>4th 0000 0000 //</p>
<p>2nd 0000 0000 //</p> <p>KING GARY</p> <p>202 E NORTHERN LIGHTS ANCHORAGE AK 99503</p>	<p>5th 0000 0000 //</p>

Alcohol Existing License List Report

Case Number: 2006-082

Description: 1000 foot alcohol

Parcel Business Name	Parcel Owner Name Applicant Name	Parcel Owner Address Business Address	City Lic. Number	State Lic. Zone	Zip Lic. Type
0090113000 China Garden	MA DANA 50% & Park, Matthew K.	2440 E TUDOR ROAD BOX 1116 204 E. Fireweed Ln	FAIRBANKS 227	AK B3	99507 Restaurant/Eating Place
00901271000 Casa Grande	COFFEY FAMILY Casa Grande, Inc.	207 E NORTHERN LIGHTS #200 201 E. Northern Lights	ANCHORAGE 3009	AK B3	99503 Beverage Dispensary
00901438000 Office Lounge, The	MARSCH KURT P & PAMELA L Abdul-Halim, Nura	8133 OLD SEWARD HWY 545 E. Northern Lights	ANCHORAGE 806	AK B3	99518 Beverage Dispensary
00901501000 Pizza Plaza	MATARAGAS EFSTATHIOS K & PJ's Pizza Plaza, Inc	601 E NORTHERN LTS BLVD 601 E. Northern Lights	ANCHORAGE 891	AK B3	99503 Restaurant/Eating Place
00902323000 Alaska Bagel, Inc.	CAL WORTHINGTON TRUST Alaska Bagel, Inc.	903 W NORTHERN LIGHTS STE 2 113 Northern Lights #1	ANCHORAGE 3557	AK B3	99503 Restaurant/Eating Place
00903709000 Harry's Restaurant	FOSS C R LIV TRUST & WELLS Harry's Bar and Grill, Inc.	3201 C ST SUITE 200 6601 Blackberry Street	ANCHORAGE 323	AK B3	99503 Beverage Dispensary
00904106000 Chuck E. Cheese's	CALAIS CO INC CEC Entertainment, Inc.	PO BOX 150305 308 E. Northern Lights	ARLINGTON 1744	TX B3	76015 Restaurant/Eating Place
00904115000 Pizza Hut #2	CALAIS CO INC Kurani, Inc.	PROPERTY TAX DEPT #0555 100 E. Benson Blvd	BENTONVILLE 3712	AR B3	72716 Restaurant/Eating Place
00904201000 Crab Pot Restaurant	SEARS ROEBUCK & COMPANY Kelly Wright Lo/Chen-Kuo Lo	3333 BEVERLY ROAD/B2-122A 600 E. N. Lights #169	HOFFMAN EST 4272	IL B3	60179 Restaurant/Eating Place
00904201000 Oaken Keg (1806)	SEARS ROEBUCK & COMPANY Oaken Keg Spirit Shops, Inc.	3333 BEVERLY ROAD/B2-122A 600 E. Northern Lights	HOFFMAN EST 795	IL B3	60179 Package Store
00904201000 Roscoe's Skyline Restaurant	SEARS ROEBUCK & COMPANY Wyche, Annie C.	3333 BEVERLY ROAD/B2-122A 600 E. Northern Lights #169	HOFFMAN EST 3788	IL B3	60179 Restaurant/Eating Place
00904333000 Peking Palace	WEDGEWOOD MORTGAGE LLC Choi, Joon K.	650 W INTL AIRPORT ROAD #200 500 E. Benson Blvd	ANCHORAGE 1691	AK B3	99518 Restaurant/Eating Place
00904334000 Café Amsterdam	SHIMEK JOSEPH R W Shauna Pajak	PO BOX 93890 530 E. Benson Blvd #3	ANCHORAGE 3961	AK B3	99509 Restaurant/Eating Place

072

2006 082 liquor licenses

Wed May 03, 13:09:09, 2006

Map: Parcels--Basic Layers



Scale 1:8000

Legend:

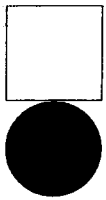

PARCELS

ALCOHOL

Txt

STRNAME_BLI

CityView™

Municipal Software Corporation

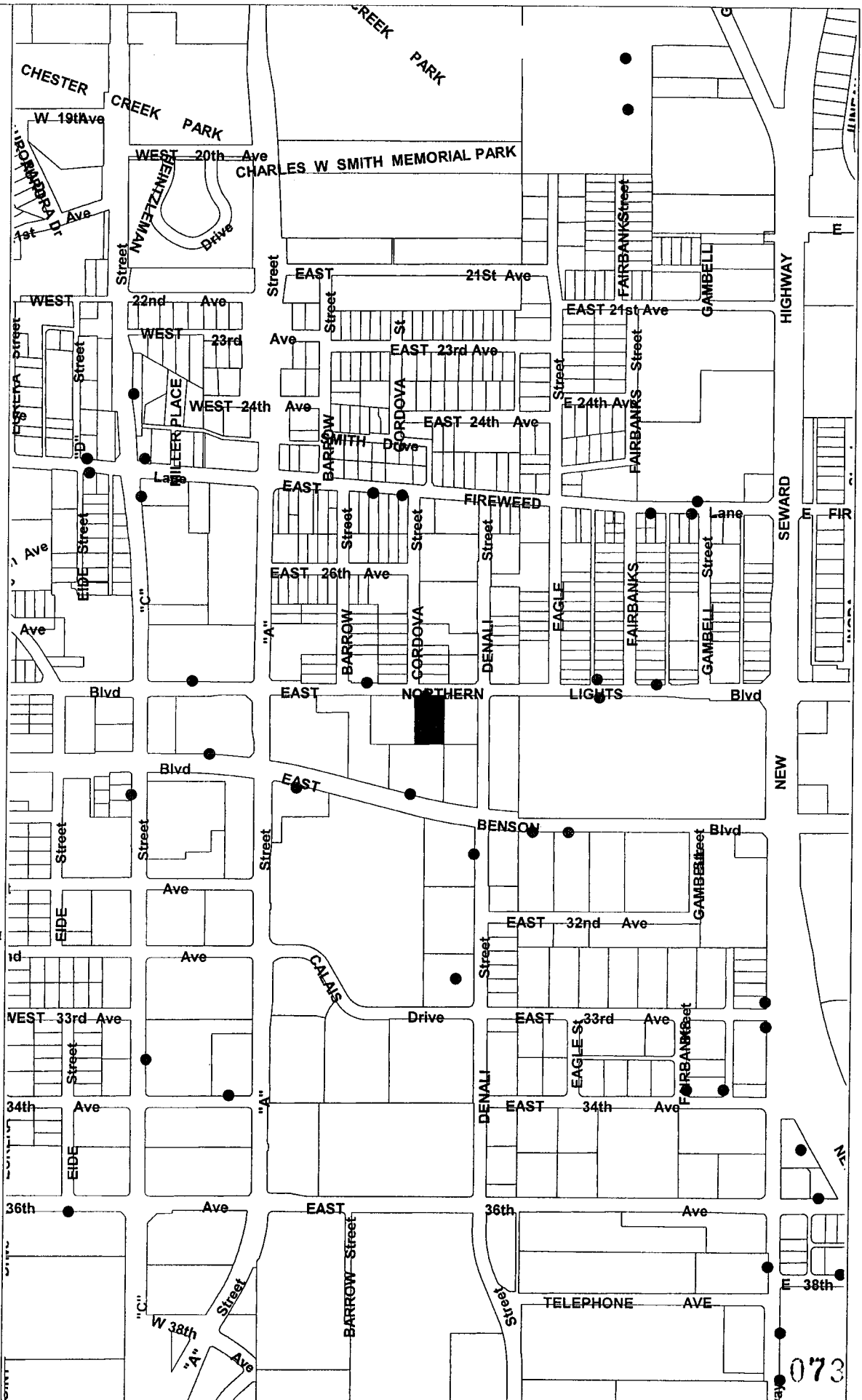

073

2006 082 liquor licenses 1000 ft

Wed May 03, 13:09:55, 2006

Map: Parcels--Basic Layers



Scale 1:8000

Legend:



PARCELS



ALCOHOL

Txt

STRNAME_BI_L

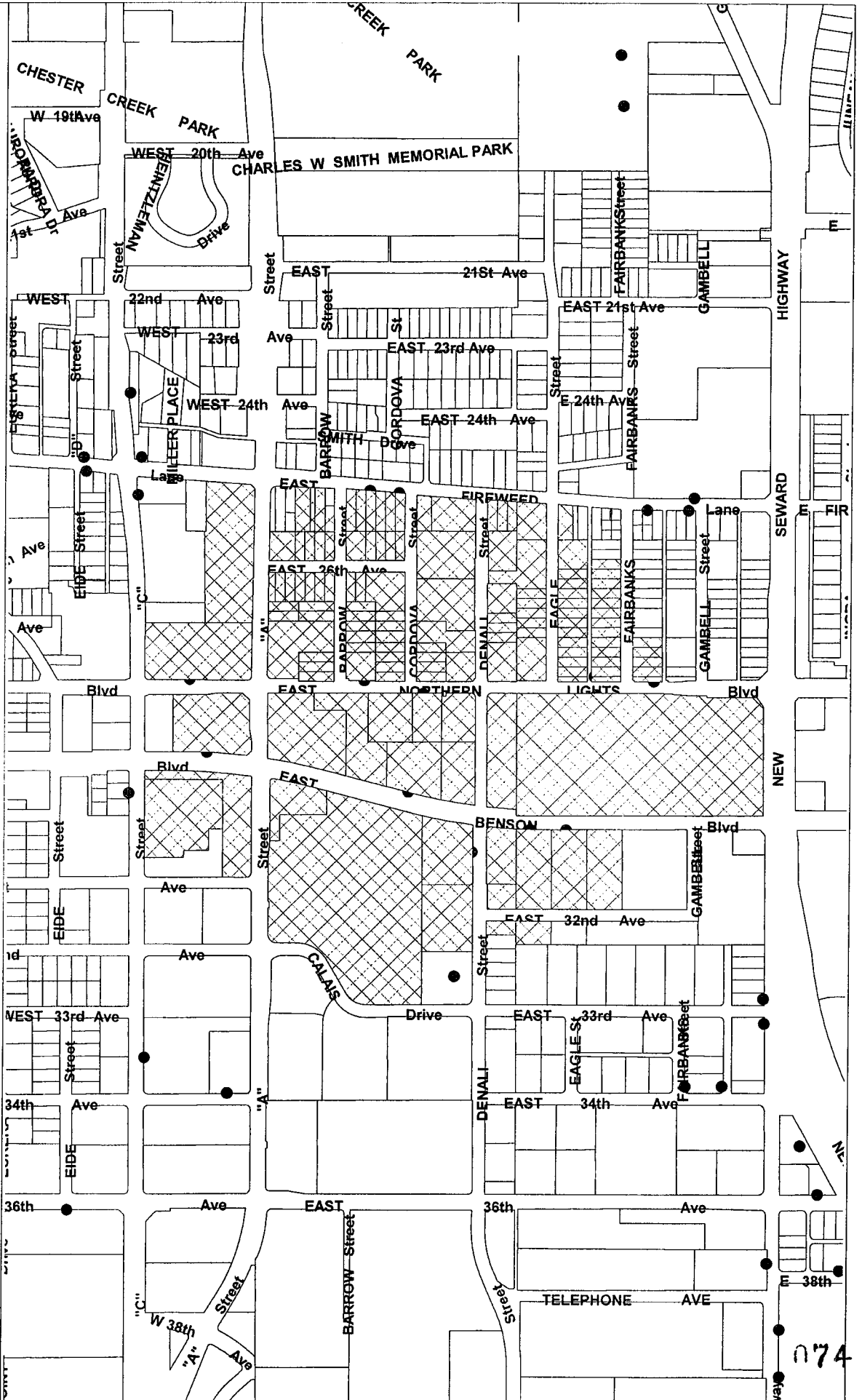

074

CityView™

Municipal Software Corporation

Alcohol Church and School List Report

Case Number: 2006-082

Description: 1000 feet

Parcel	Parcel Owner Name	Parcel Site Address	Description
--------	-------------------	---------------------	-------------

CEC

entertainment

4441 W. AIRPORT FRWY.
IRVING, TEXAS 75062
(T) 972.258.8507
(F) 972.258.8545

Alice Winters
Director of Licensing
Phone: 972-258-5523
Fax: 972-258-5534

August 8, 2006

Mary Autor
Zoning Officer
Municipality of Anchorage
4700 S. Bragaw
Anchorage, Alaska 99507
Ph: 907/343-7941

M.O.A.
2006 AUG - 8 PM 3: 52
CLERKS OFFICE

Re: Chuck E. Cheese's #589
308 E. Northern Lights Boulevard
Anchorage, Alaska 99503

Dear Ms. Autor:

CEC Entertainment, Inc. dba Chuck E. Cheese's respectfully requests Case #2006-082
Minor Amendment to an existing Alcoholic Beverage Conditional Use be withdrawn.

If you have questions or need additional information, please let me know.

Sincerely,

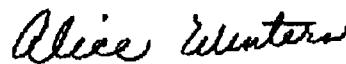

Alice Winters

Content Information**Content ID :** 004064**Type:** AR_AllOther - All Other ResolutionsMINOR AMENDMENT TO AN EXISTING ALCOHOLIC BEVERAGES
CONDITIONAL USE IN THE B-3 DISTRICT FOR A**Title:** RESTAURANT/EATING PLACE PER AMC 21.40.180 D.8 FOR CHUCK
E. CHEESE RESTAURANT LOCATED IN THE CALAIS SUBDIVISION,
TRACT D3, LOCATED AT 308 EAST NORTHERN LIGHTS BOUL**Author:** weaverjt**Initiating Dept:** PlanningMINOR AMENDMENT TO AN EXISTING ALCOHOLIC BEVERAGES
CONDITIONAL USE IN THE B-3 DISTRICT FOR A**Description:** RESTAURANT/EATING PLACE PER AMC 21.40.180 D.8 FOR CHUCK
E. CHEESE RESTAURANT**Date Prepared:** 6/9/06 11:01 AM**Director Name:** Tom Nelson**Assembly**
Meeting Date ~~7/25/06~~ 9/12/06
MM/DD/YY:**Workflow History**

<u>Workflow Name</u>	<u>Action Date</u>	<u>Action</u>	<u>User</u>	<u>Security Group</u>	<u>Content ID</u>
AllOtherARWorkflow	6/9/06 11:04 AM	Checkin	weaverjt	Public	004064
Planning_SubWorkflow	6/9/06 3:54 PM	Approve	nelsontp	Public	004064
ECD_SubWorkflow	6/9/06 4:49 PM	Approve	thomasm	Public	004064
MuniManager_SubWorkflow	6/30/06 9:48 AM	Approve	leblancdc	Public	004064
MuniMgrCoord_SubWorkflow	6/30/06 2:08 PM	Approve	abbottmk	Public	004064

M.O.A.
2006 JUL -3 AM 9:35
CLERKS OFFICE